

Anbauanleitung Seilwindenanbausatz VW T5 (GP)

Best.-Nr.: 16-535 plus Zusatzkit 16 - 535010

AL: 1174 – 03

Ab Bj. 2010 Fgstnr.: 7H-A-200 001

Die Anleitung für ältere Modelle befindet sich im Anschluss dieser Anleitung ab Seite 30 !

The manual for models before 2010, you will find on page 30!



Hier sehen sie den fertig montierten Seilwindenanbausatz.
Bevor sie mit der Montage beginnen lesen sie bitte diese Anleitung
und das Benutzerhandbuch der Seilwinde gut durch.

Stückliste

Seilwindenanbausatz VW T5

Best.nr.: 16-535

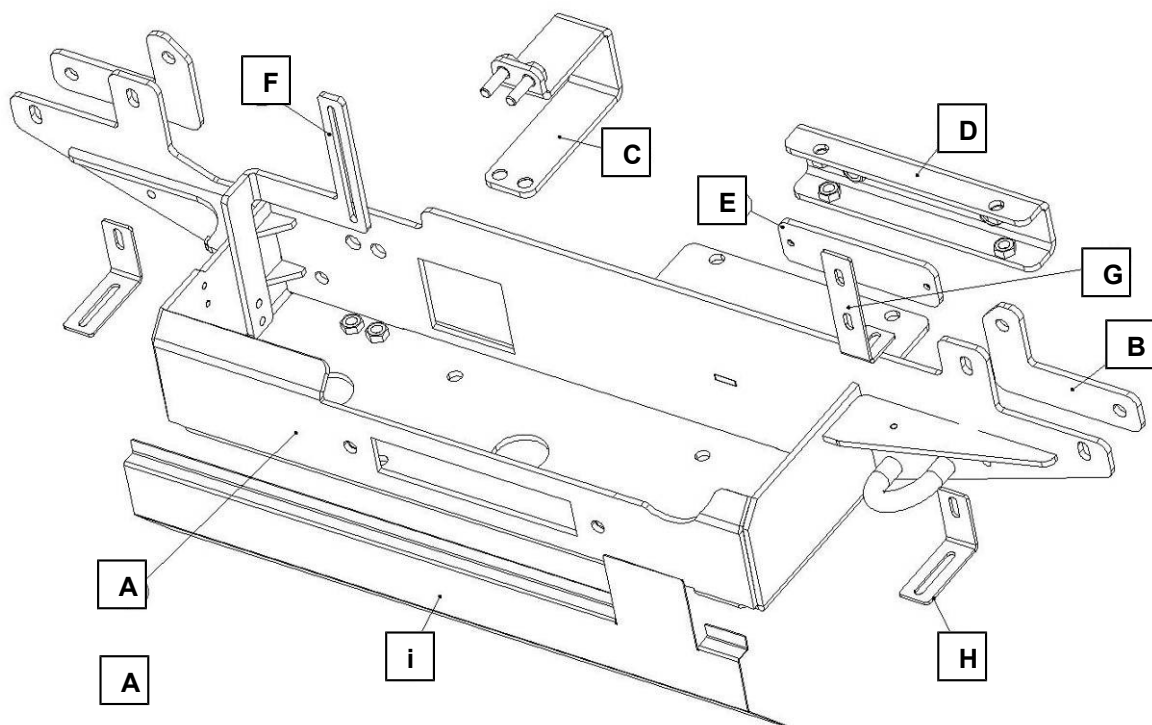

<p>1 x Seilwindenträger (A) 2 x Verstärkungsblech (B) 1 x Sicherungsbügel (C) 1 x Klemmstück (D) 1 x Druckplatte (E) 1 x Schaltkastenhalter (F) bis 2010 1 x Schablone (i) bis 2010</p> <p>1 x Schaltkastenhalter (G) ab 2010 2 x Stoßfängerhalter (H) ab 2010 1 x Anleitung AL 1174 1 x Gutachten</p>	<p>2 x Schraube M 12 x 60 2 x Federring M 12 4 x U – Scheibe M 12 4 x Mutter M 12</p> <p>4 x Senkkopfschraube M10 x 25 2 x Schraube M 10 x 25 4 x Schraube M 10 x 50 6 x Federring M 10 10 x U – Scheibe M 10 4 x Mutter M 10</p> <p>2 x Schraube M 6 x 20 2 x Federring M 6 2 x U – Scheibe M 6 x 20 x 2</p>
<p>Zusatzkit 16- 53510 für Modelle ab 2010 bestehend aus:</p> <p>1 x Steckdose 1-90394 ab 2010 1 x Freilaufhebel 1- 82463-K ab 2010 2 x 1100 mm Kabel 35² (F1u.F2) ab 2010 1 x 1000 mm Kabel 35² (A) ab 2010 6 x Rohrkabelschuh 35²-8mm ab 2010</p>	<p>2 x Mutter M 6 3 x U- Scheibe M 6 x20x2 1 x Federring M 6 1 x Schraube M 6 x 16</p>



1



2

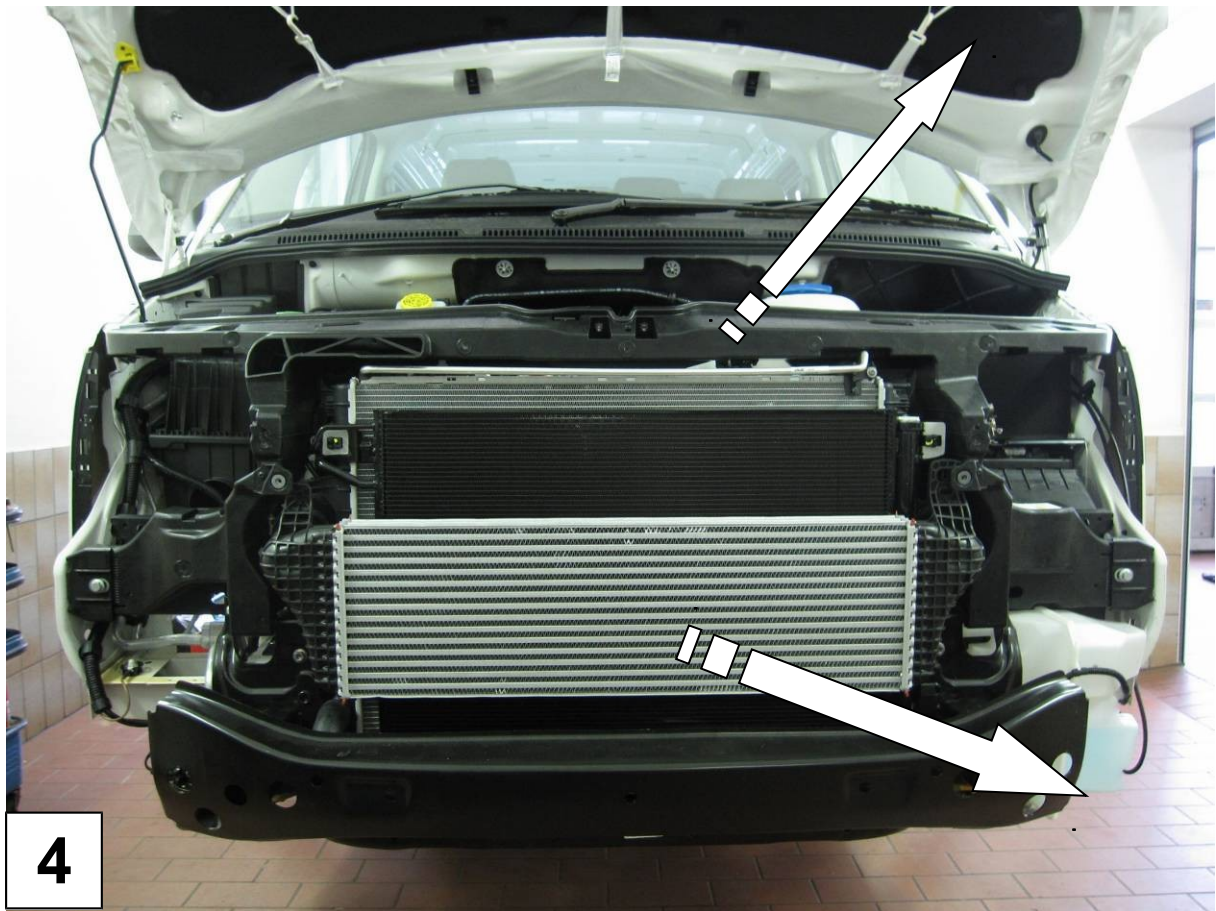

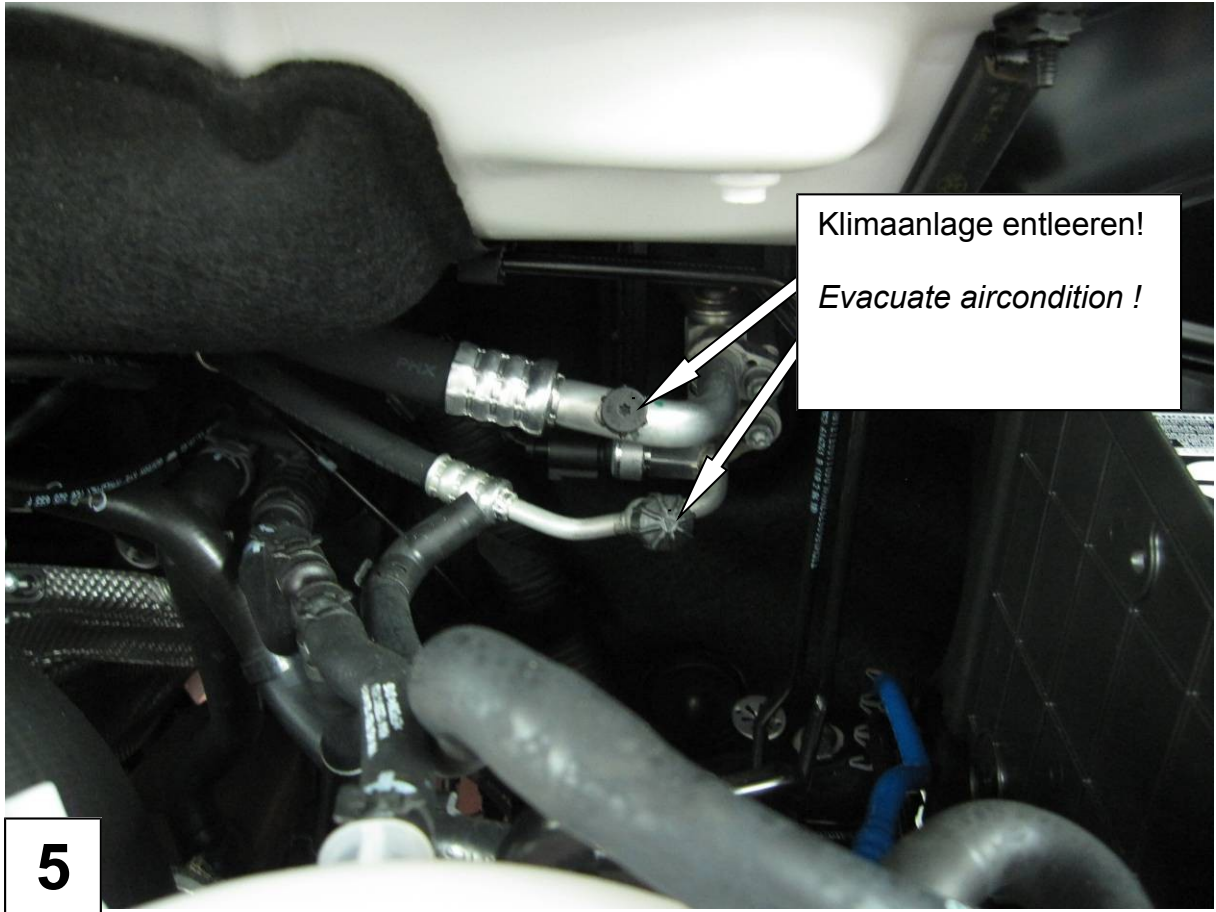

5



6

Bild/ picture 7-8
Leitungen der Klimaanlage trennen
und verschließen !
*Disconnect aircondition tubes and
close them !*

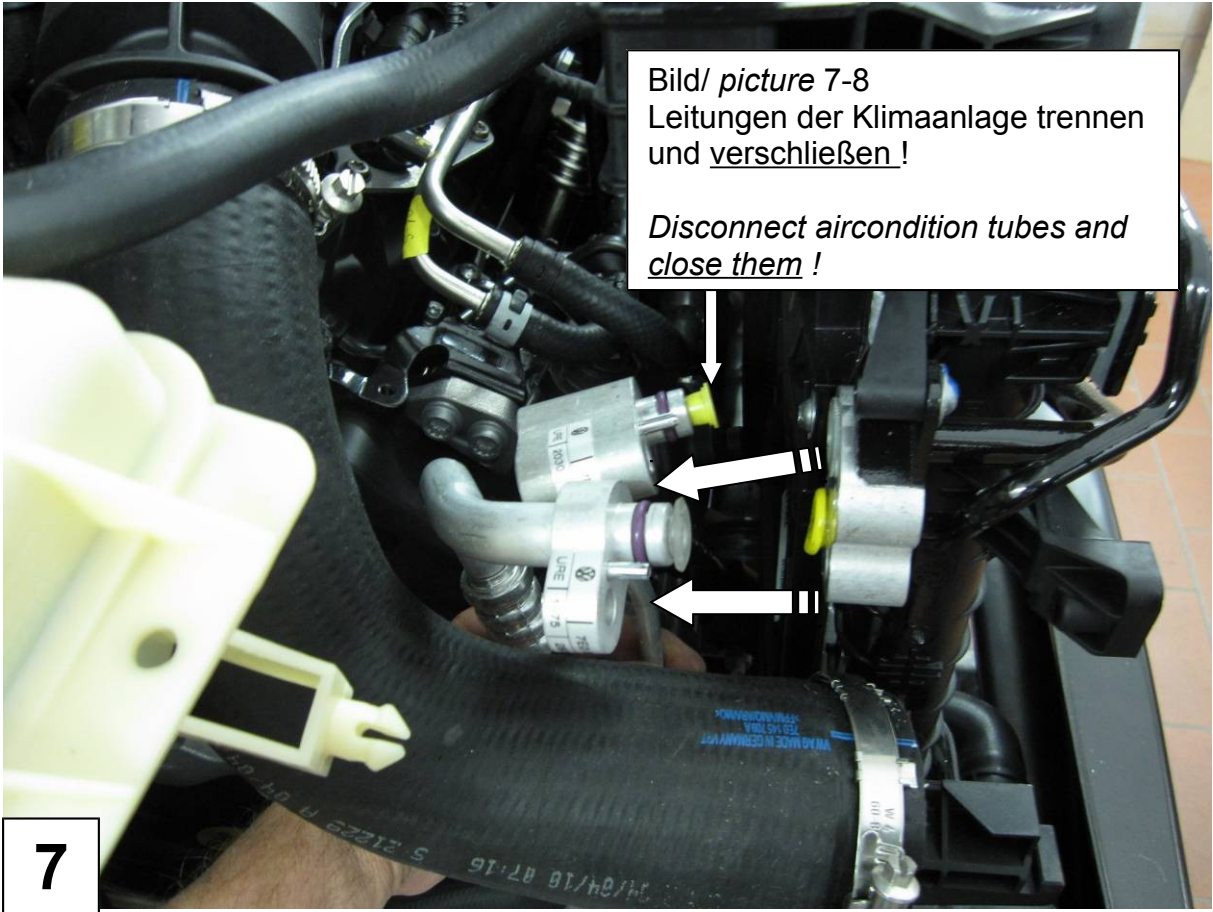

7

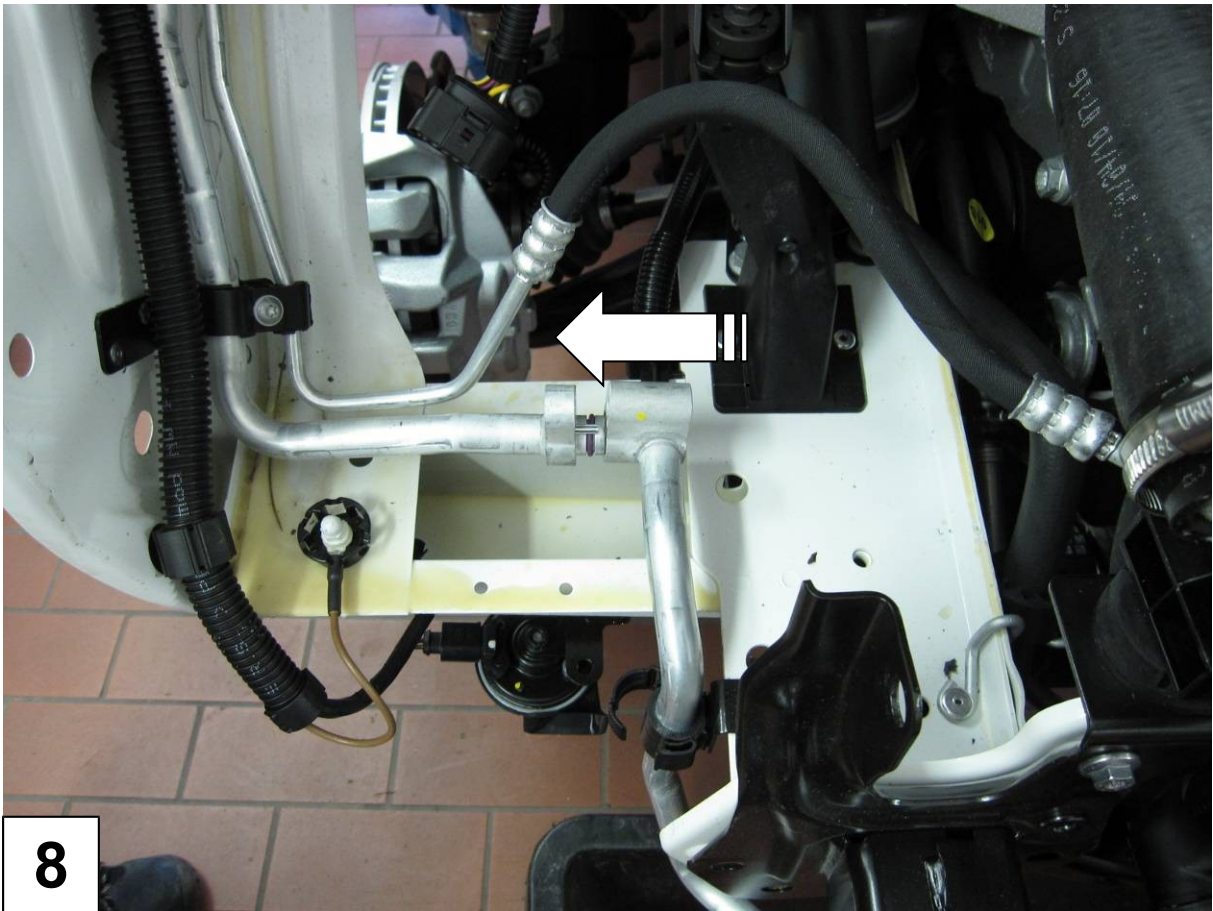

8

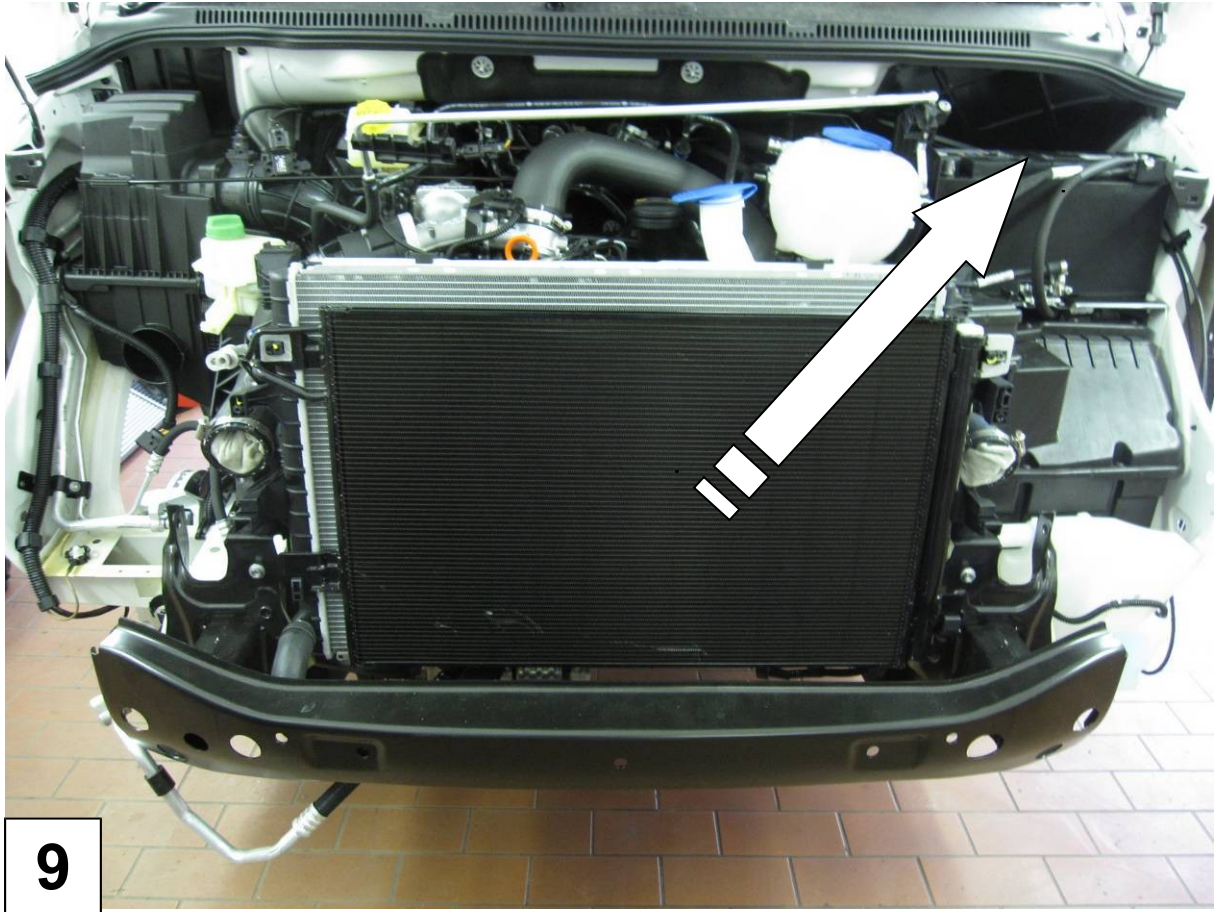

9

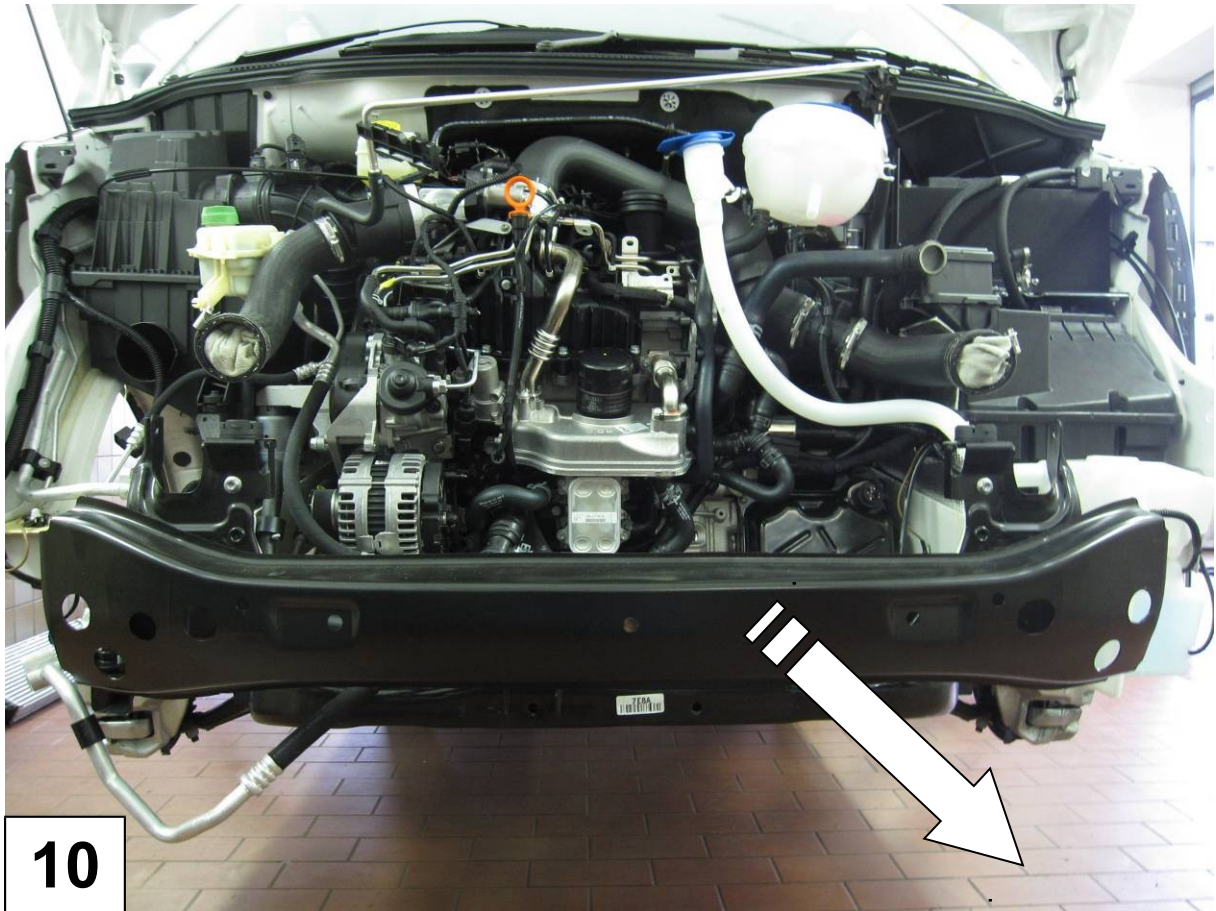

10

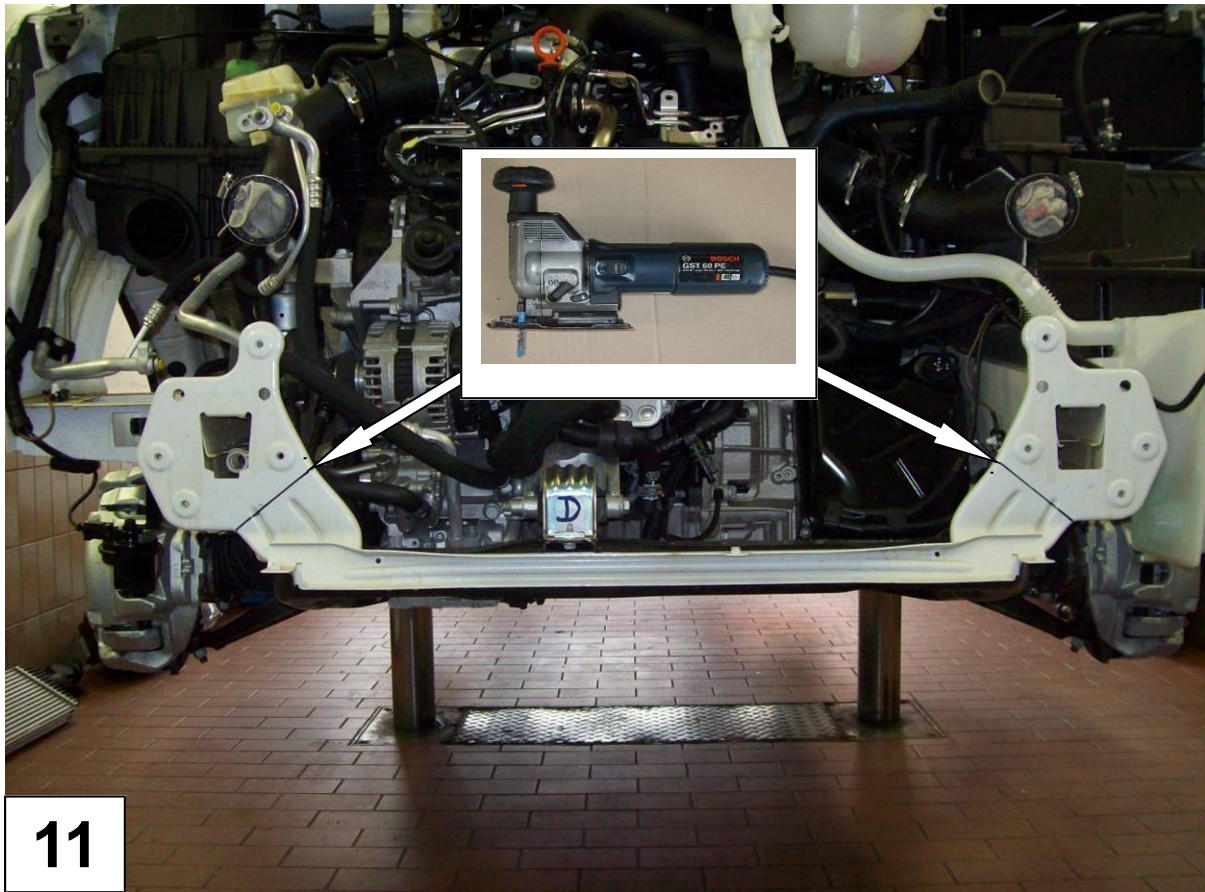

11

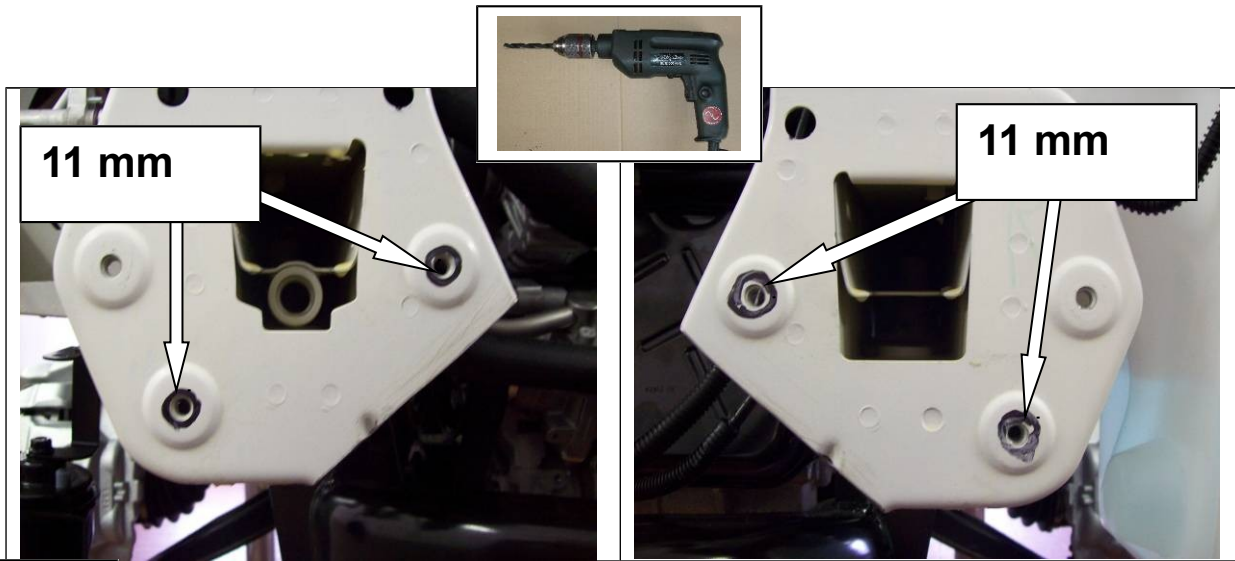

12

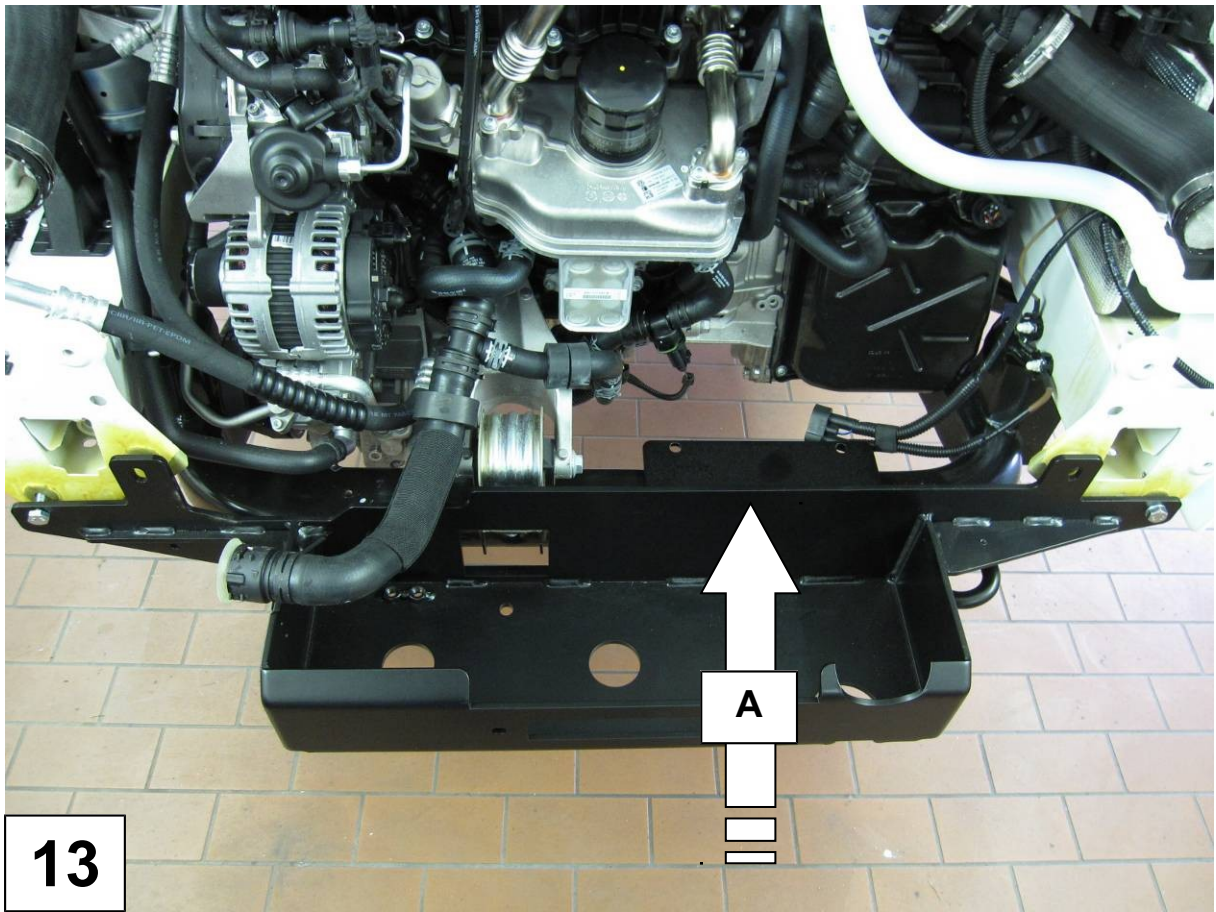

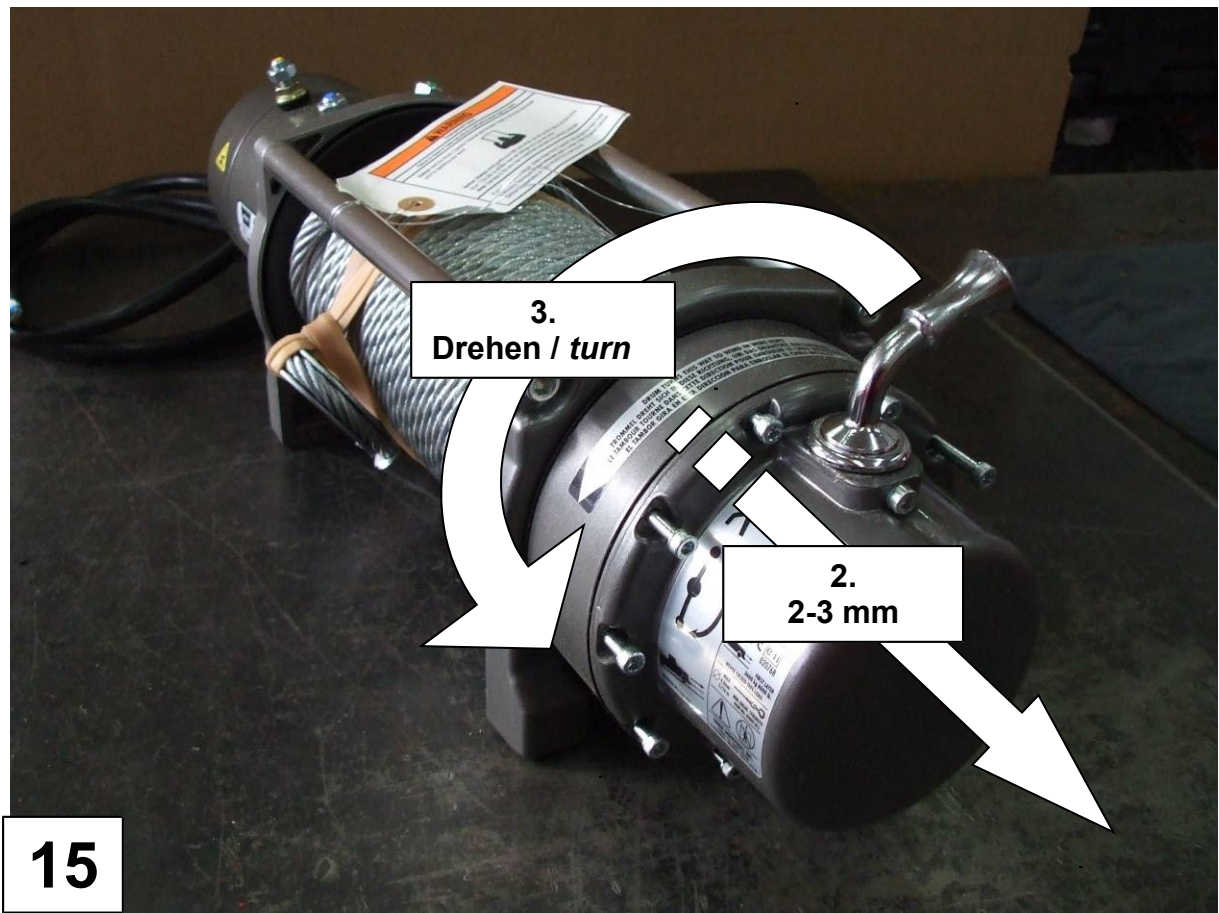

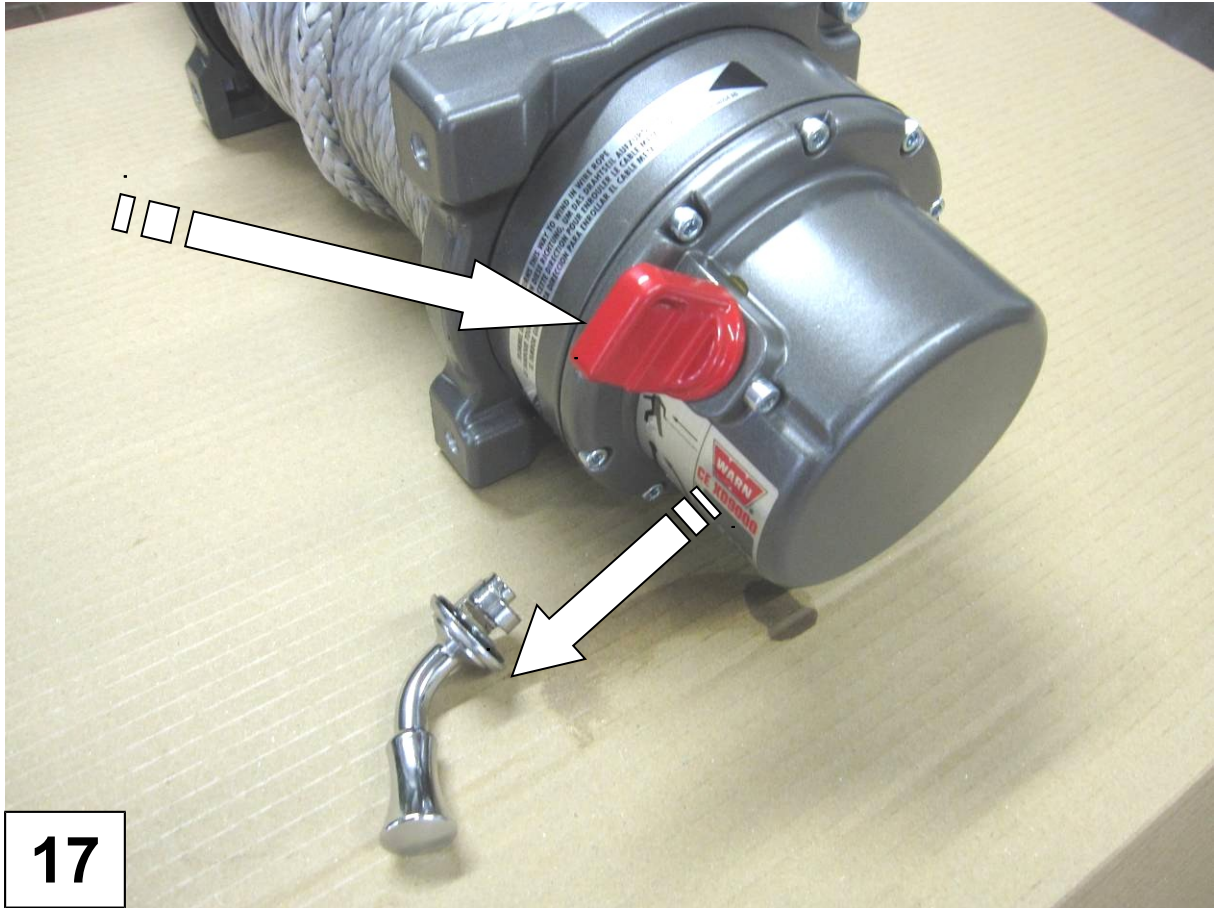

17

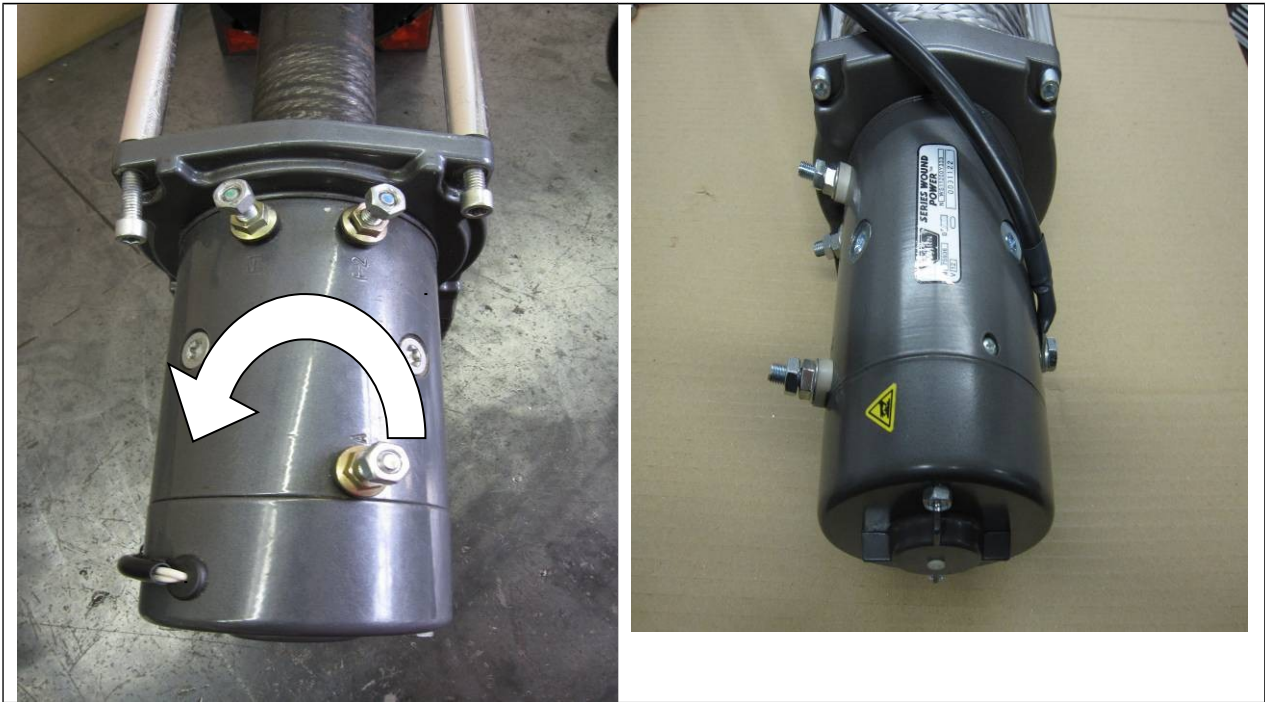

18

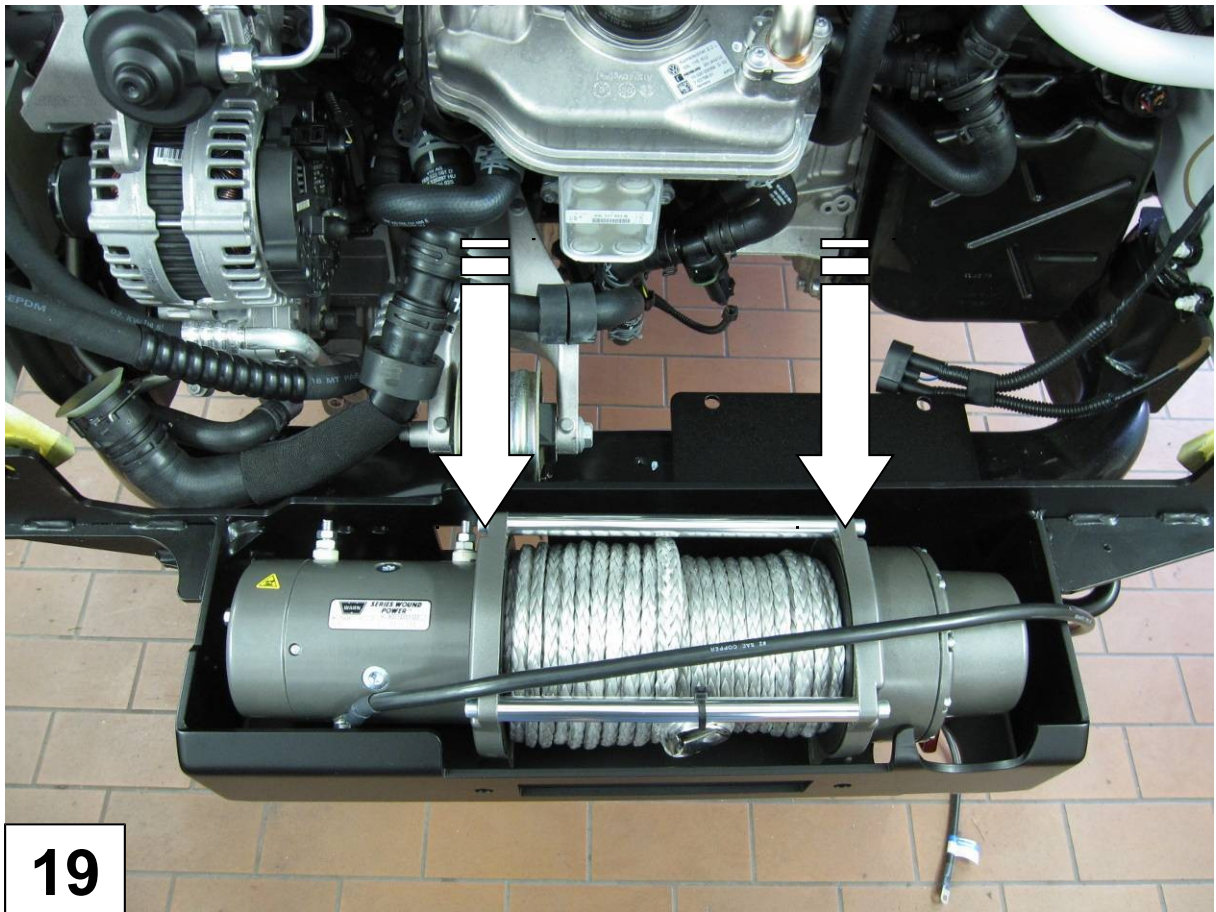

19

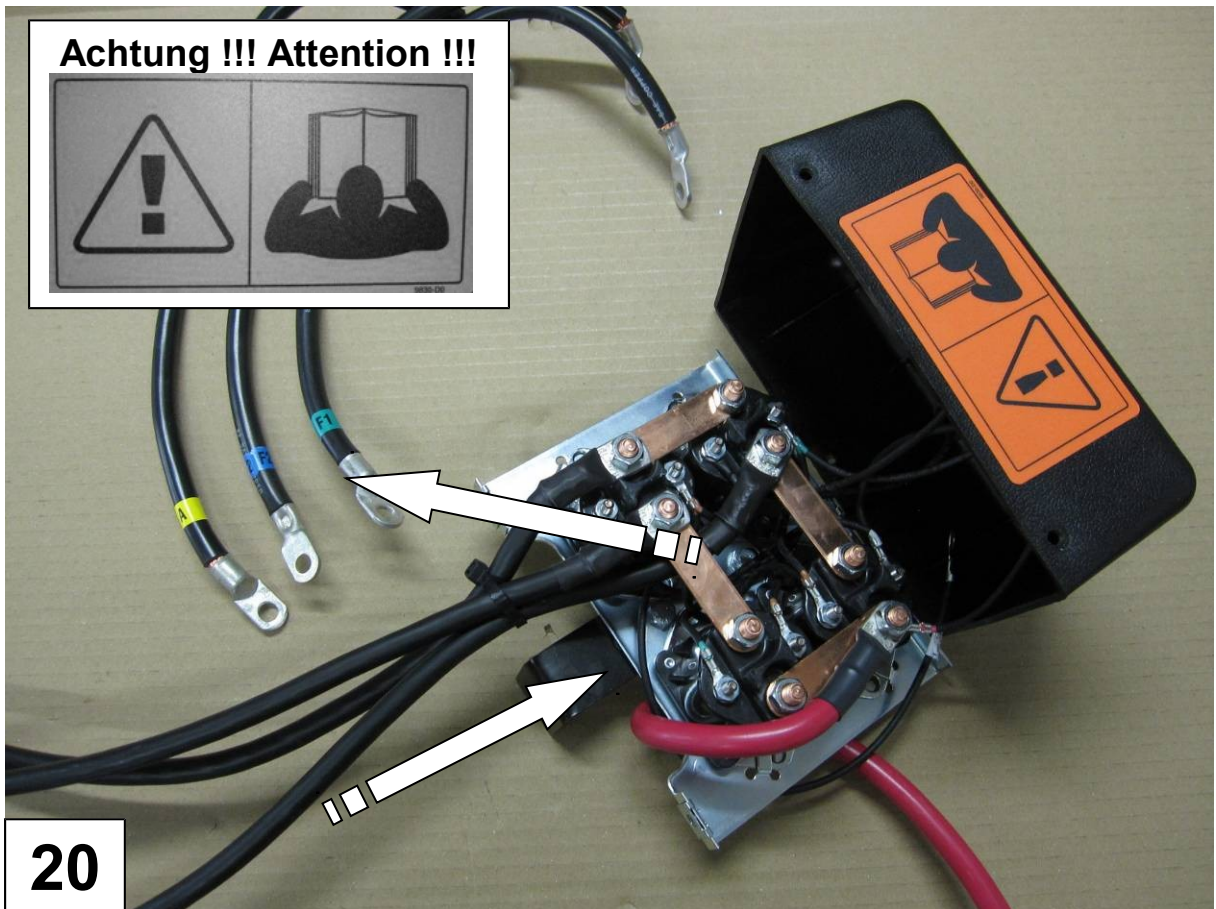

20

Achtung !!! Attention !!!

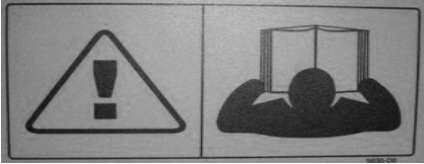

21

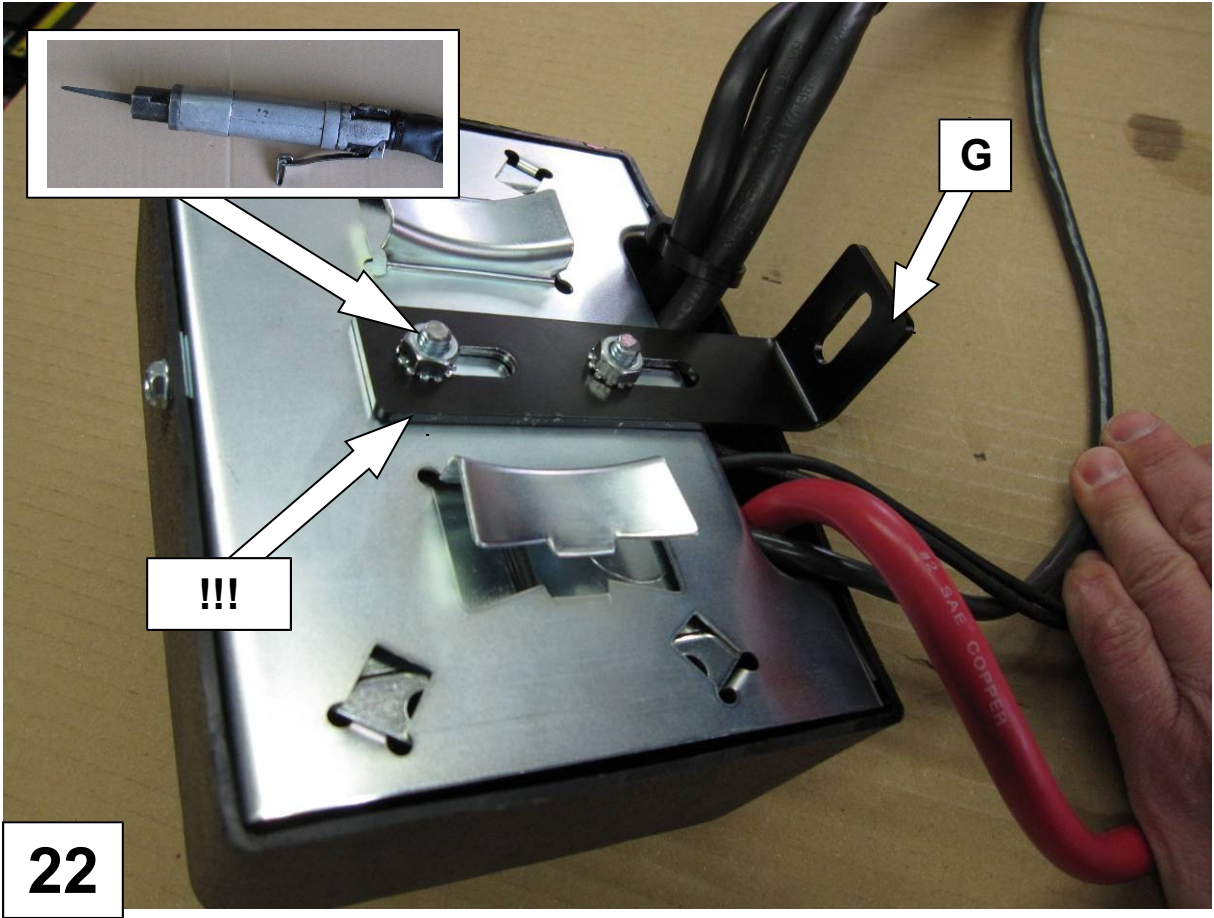
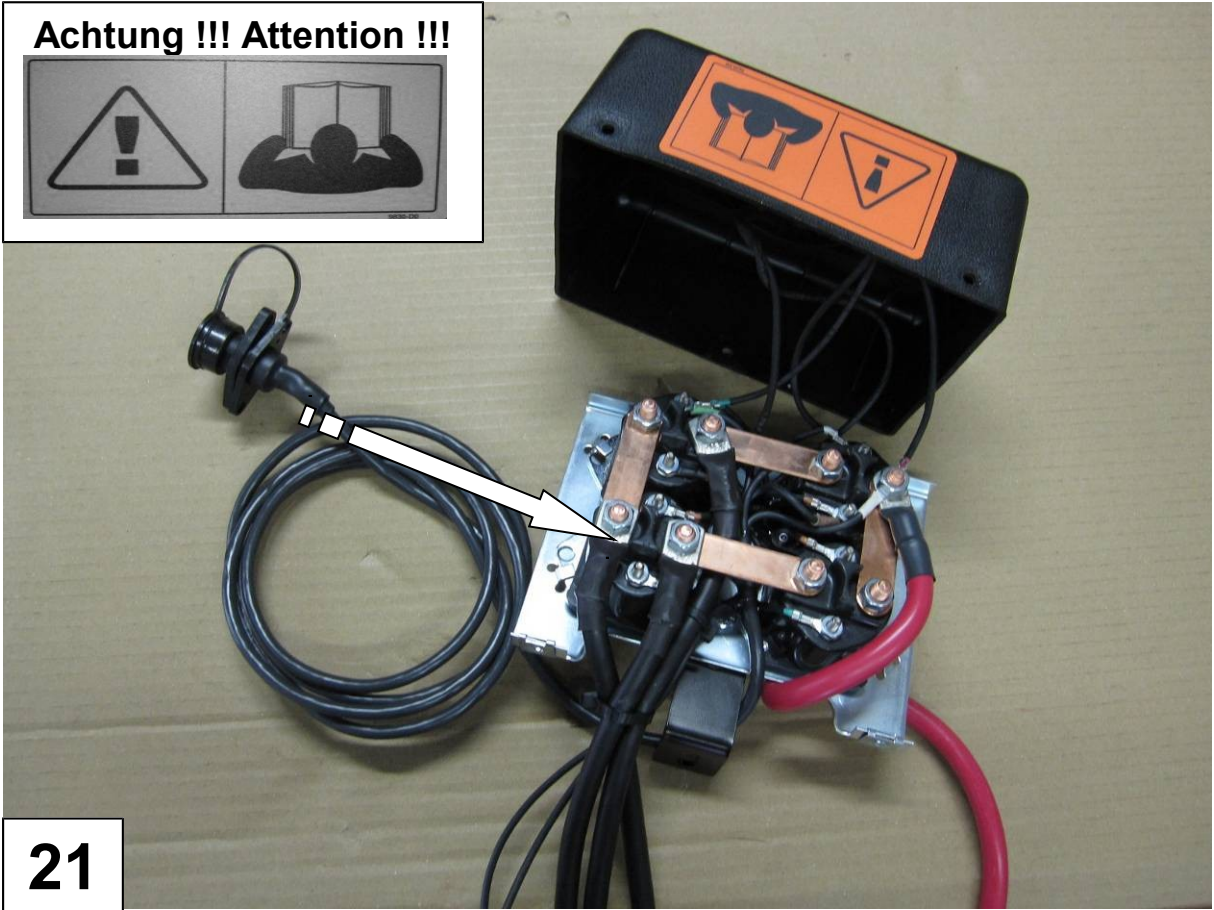

22





25

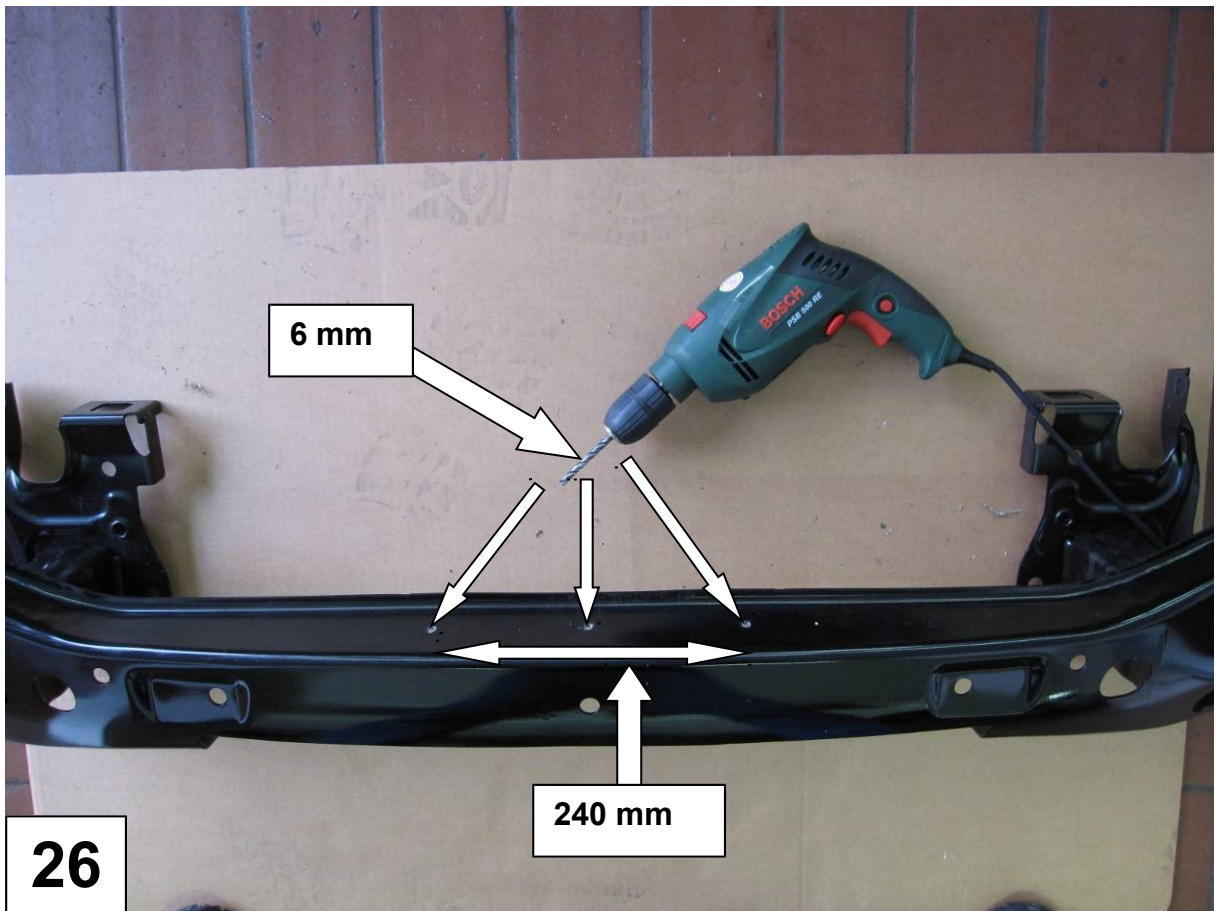

26

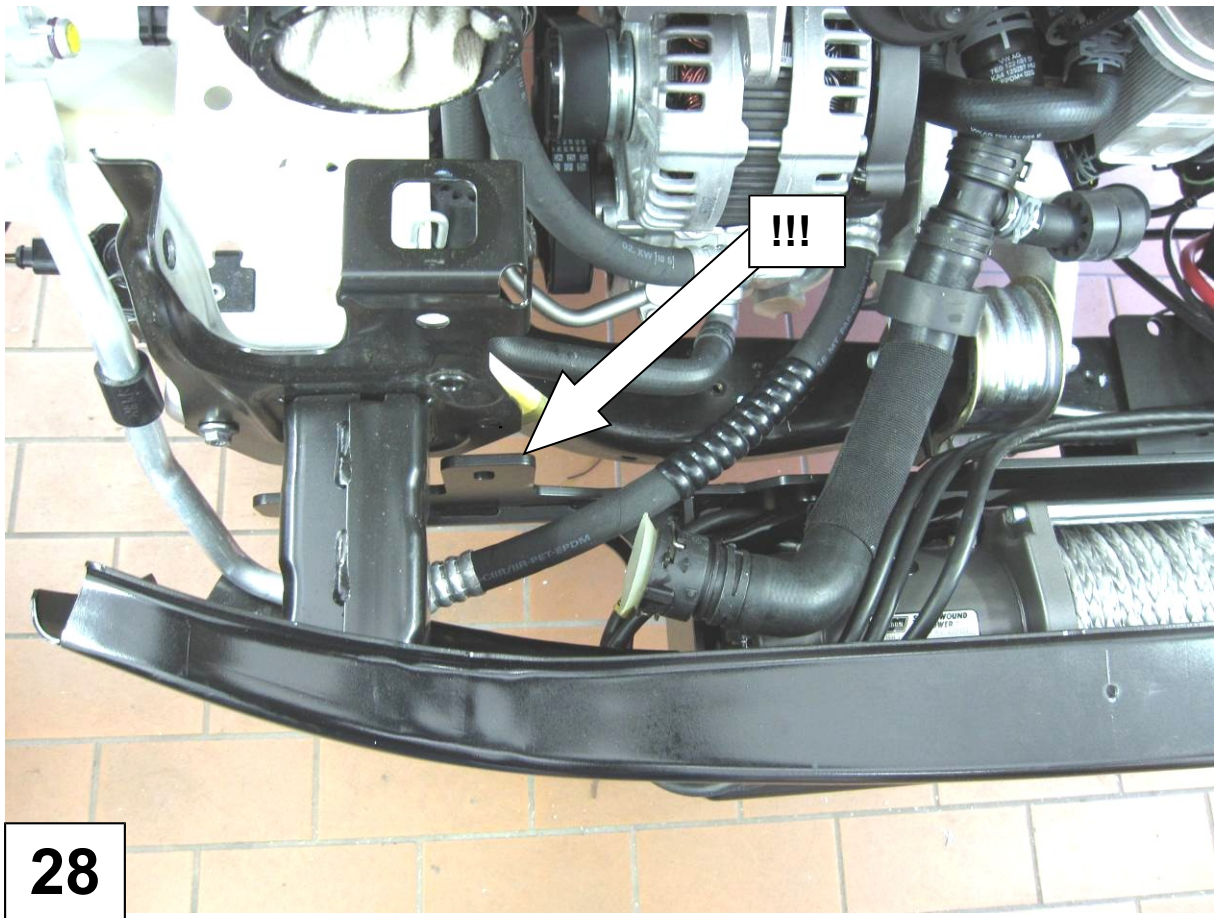

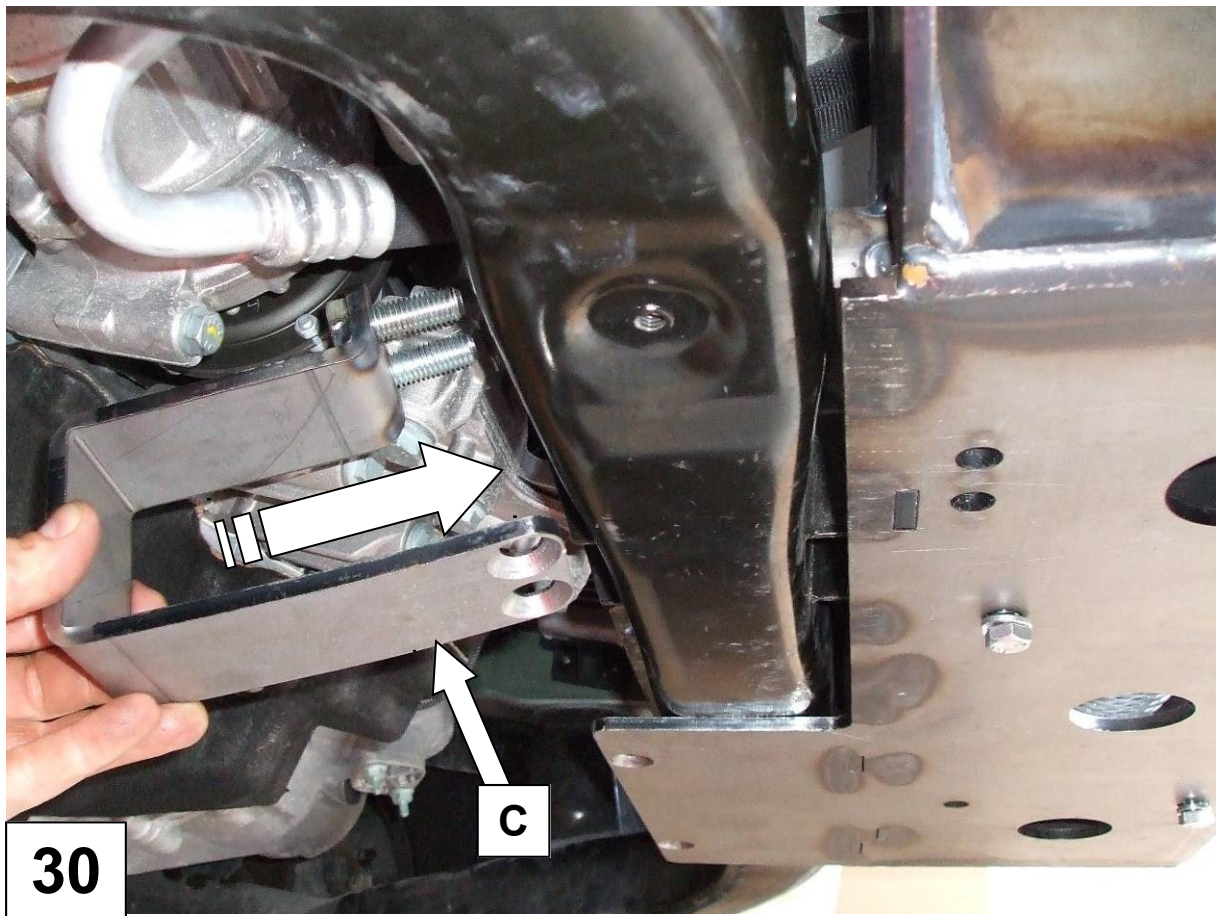
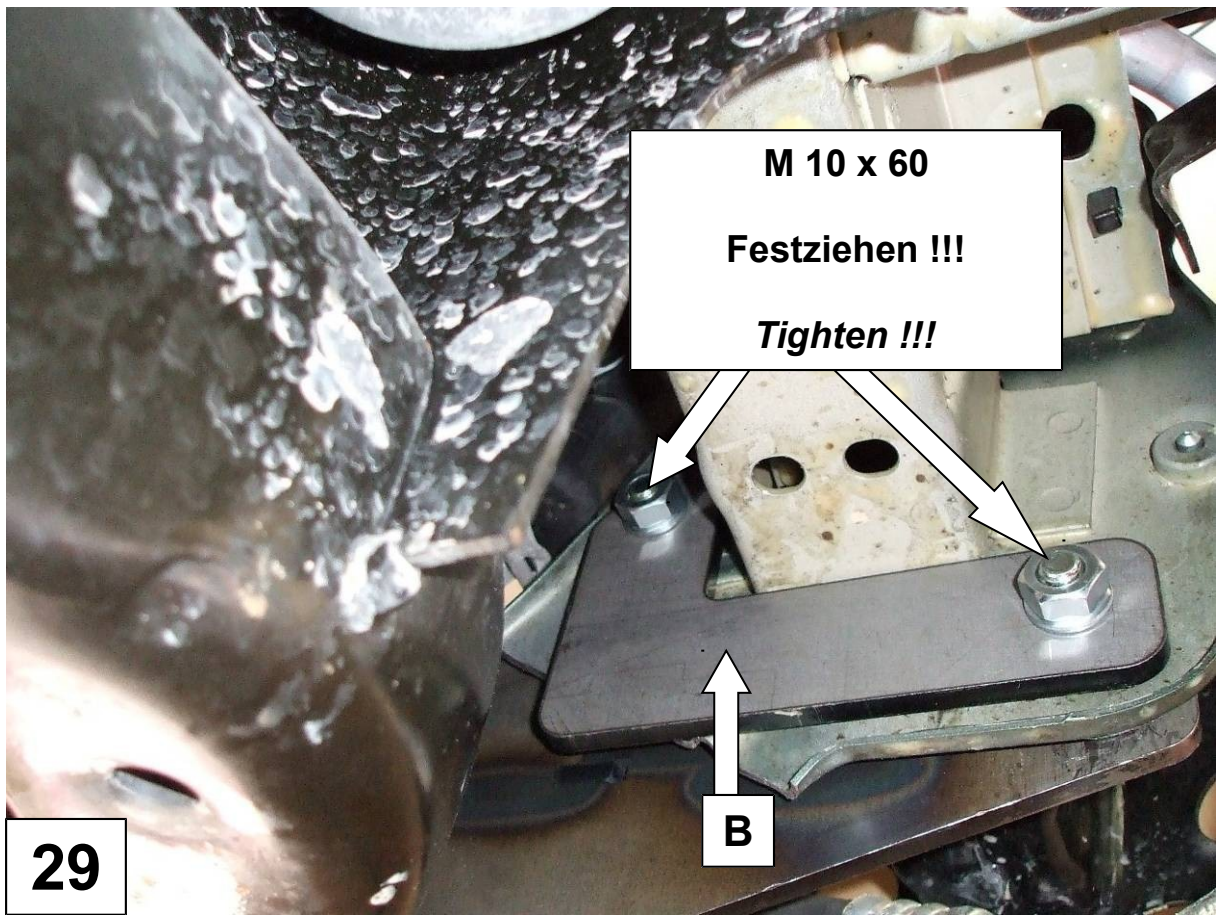

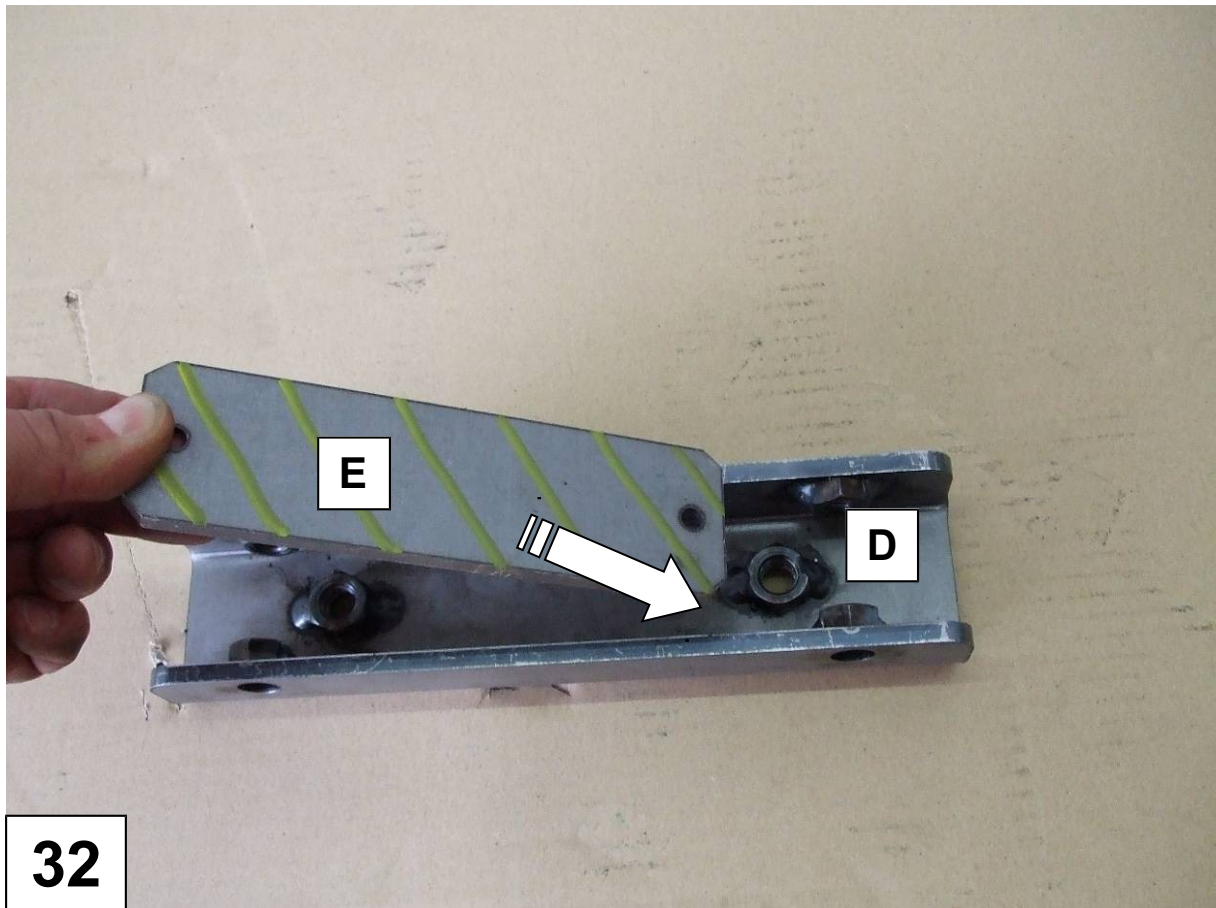
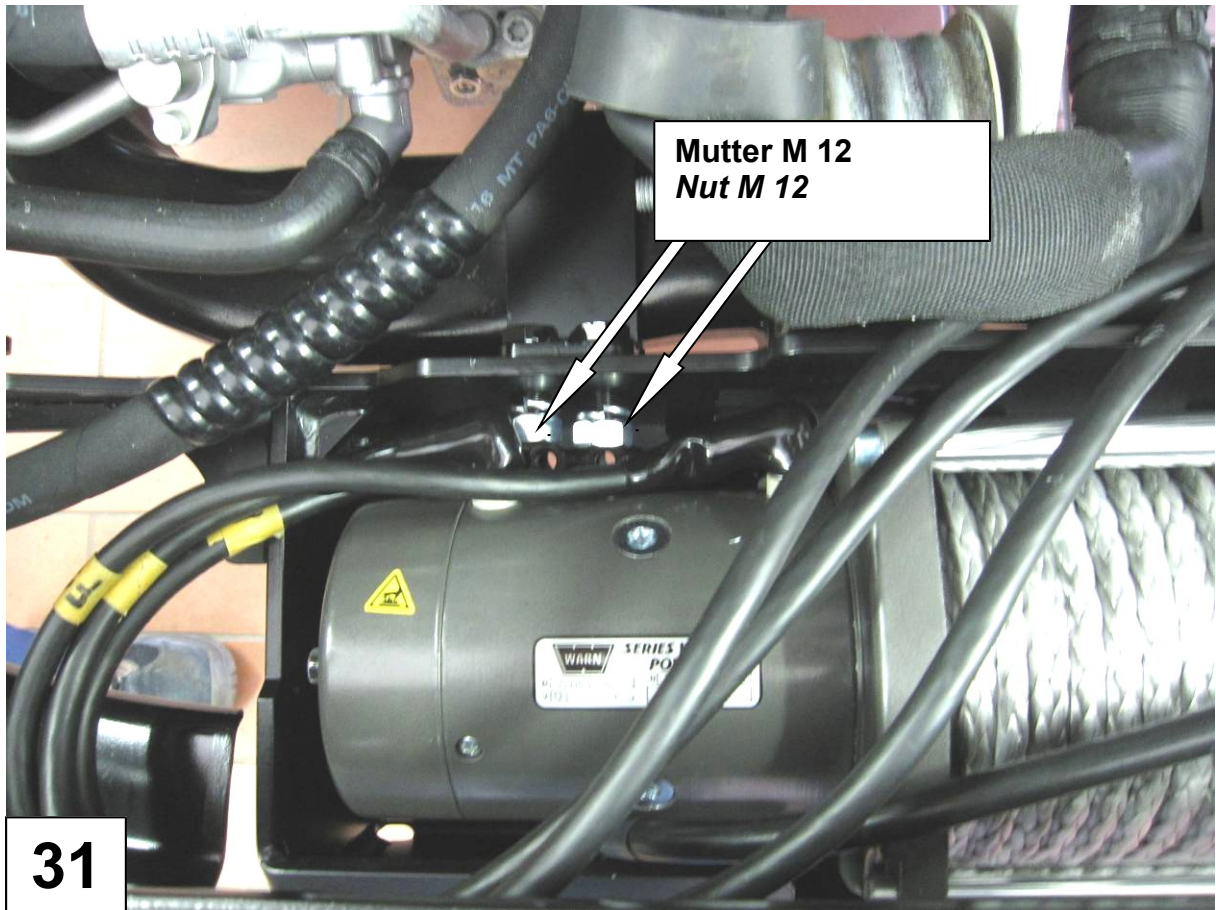

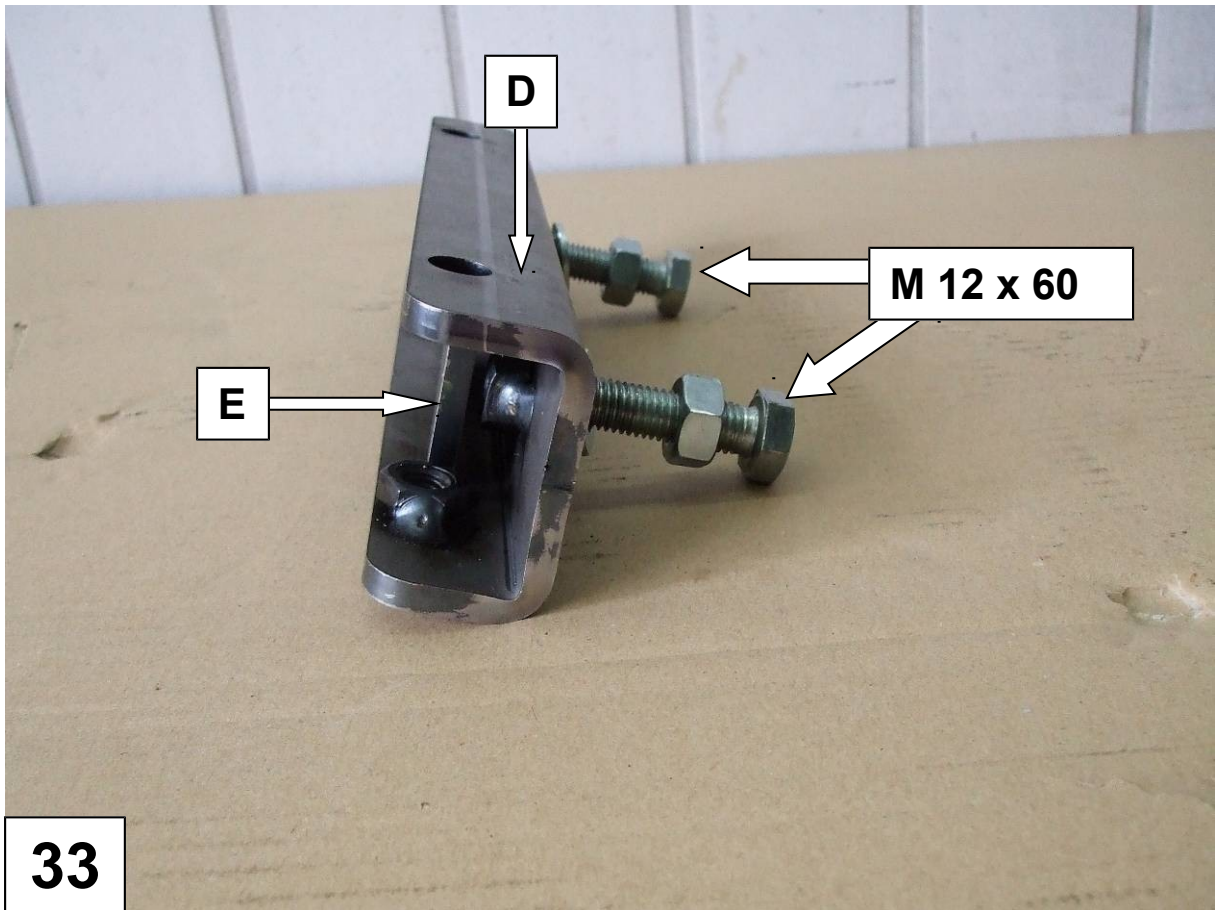

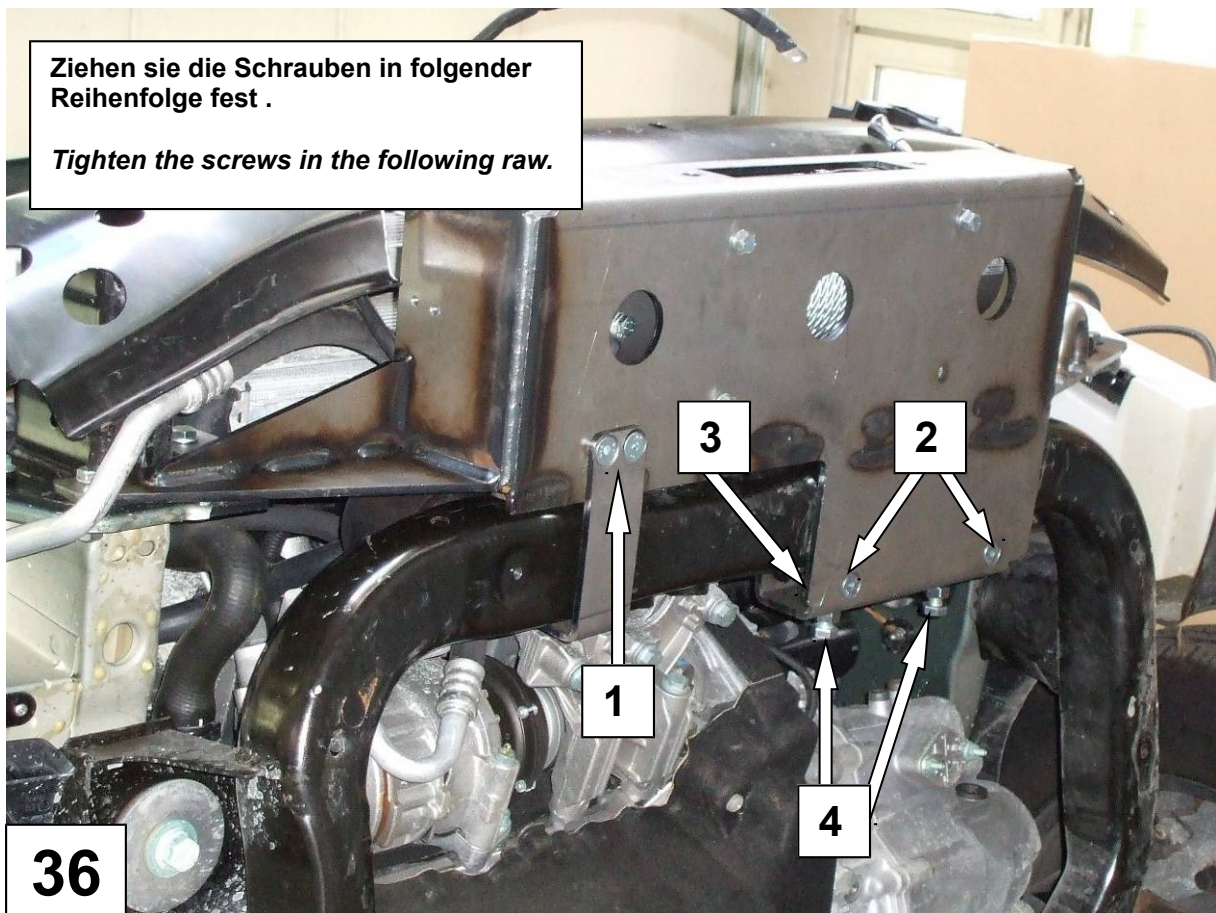
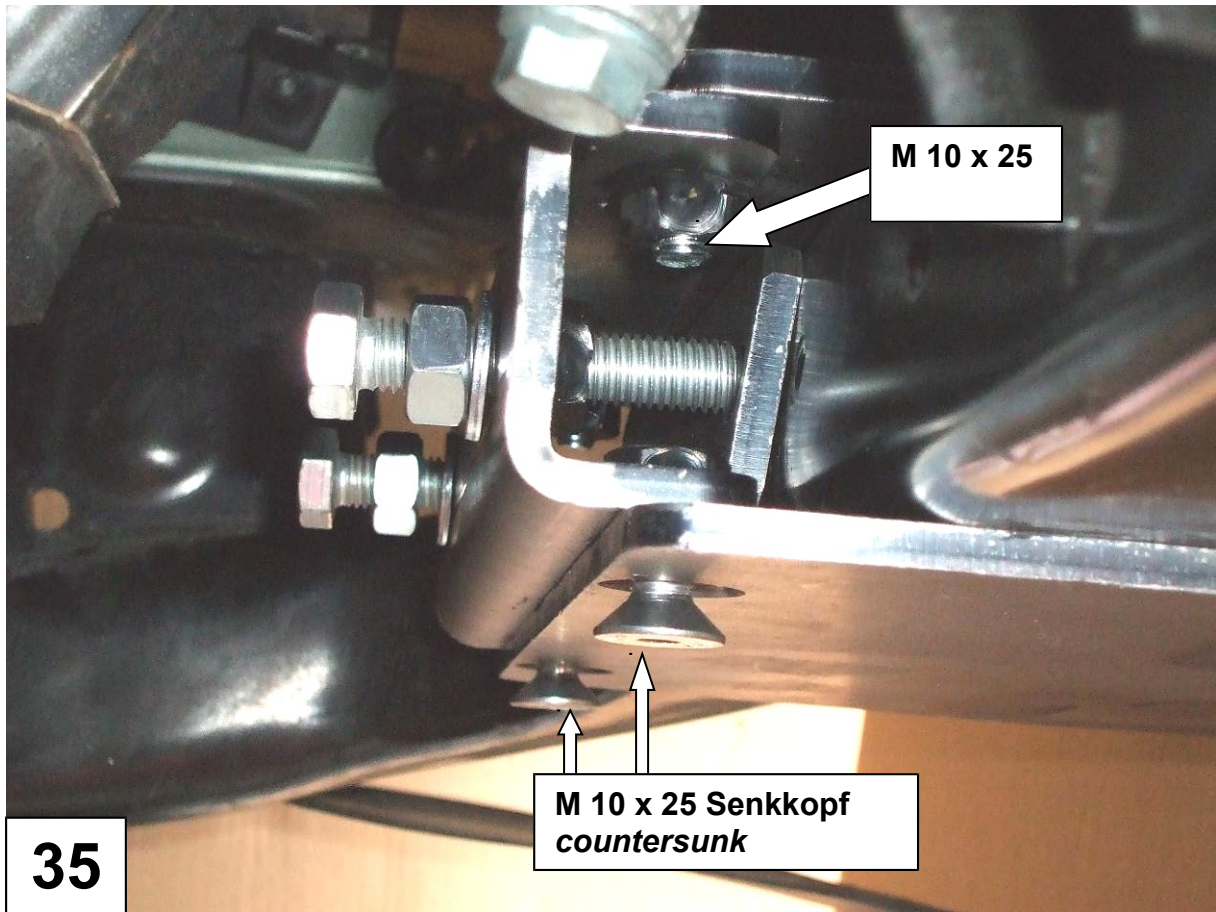

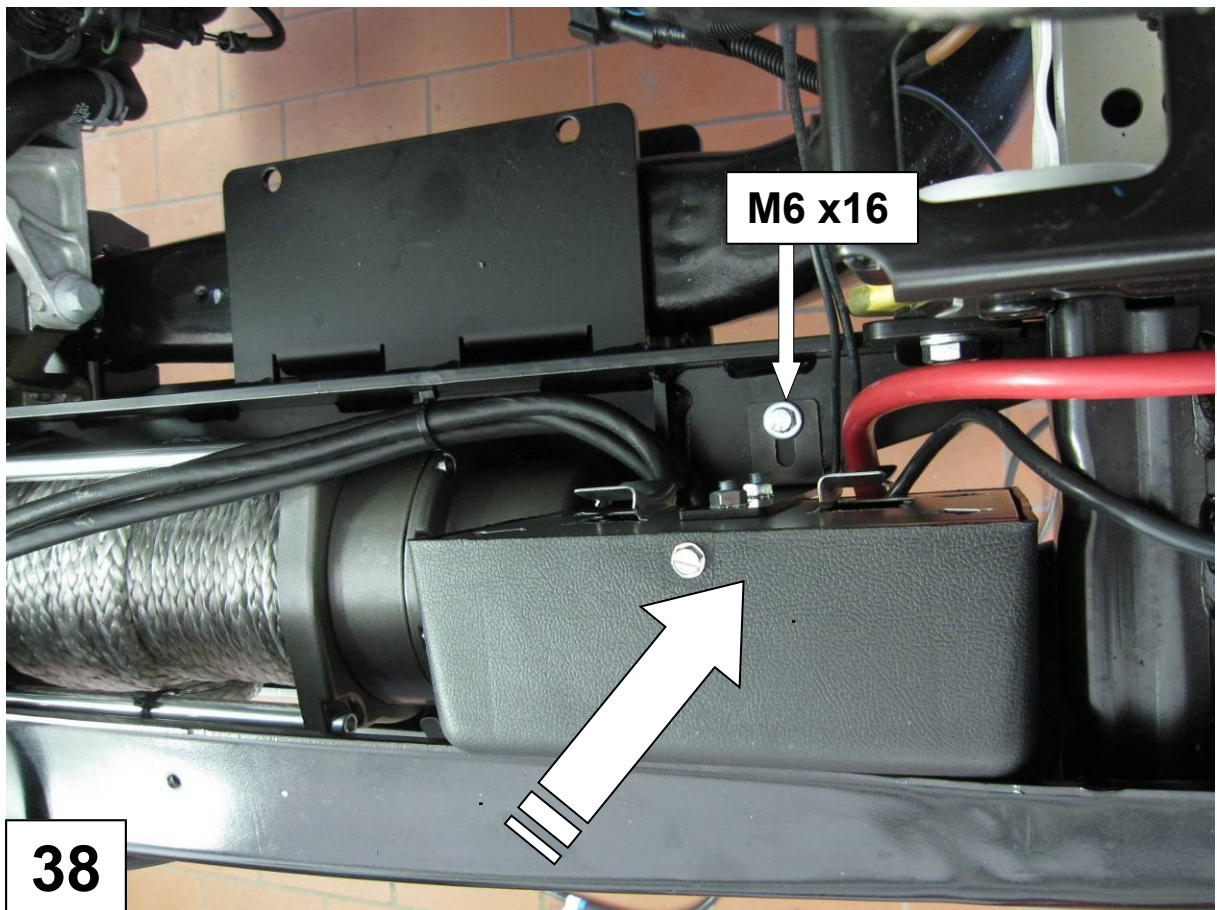
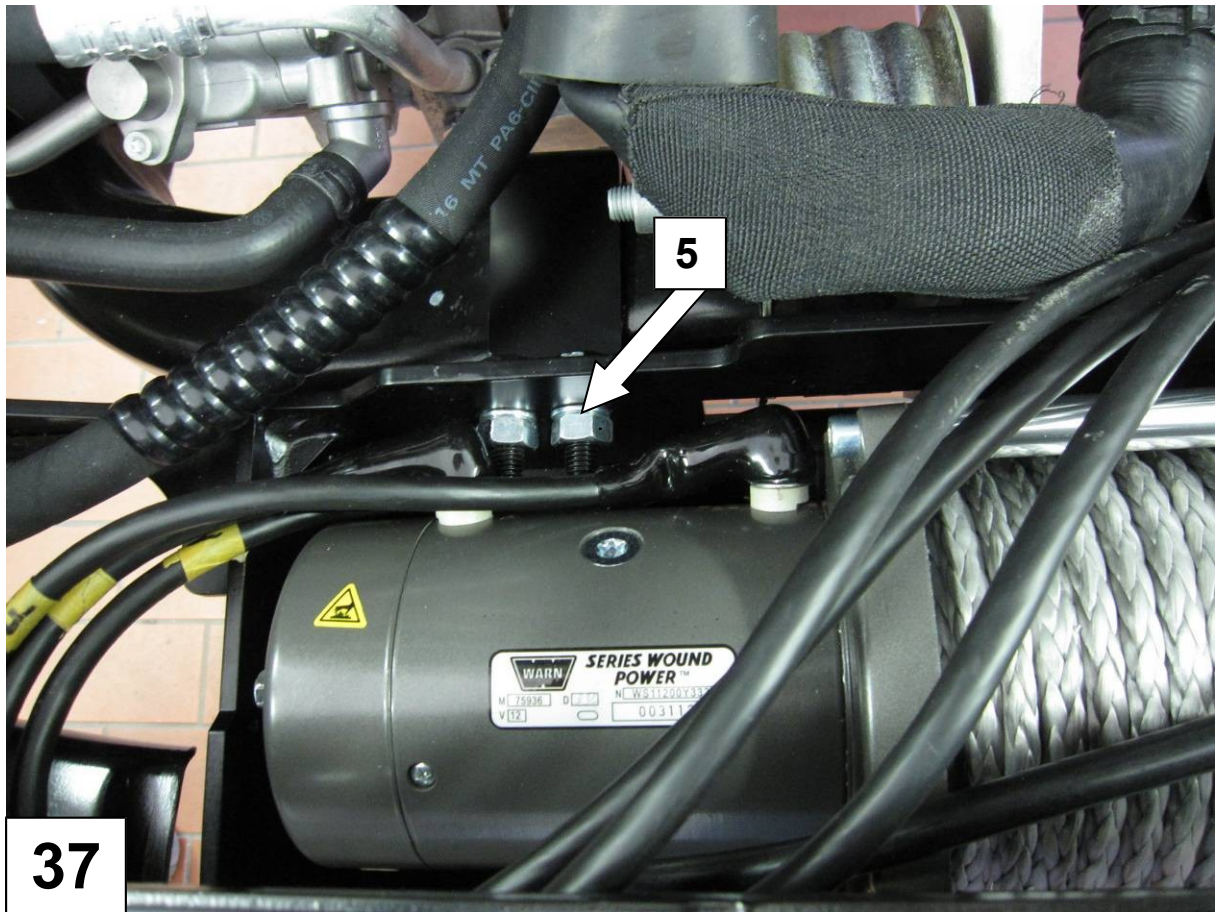

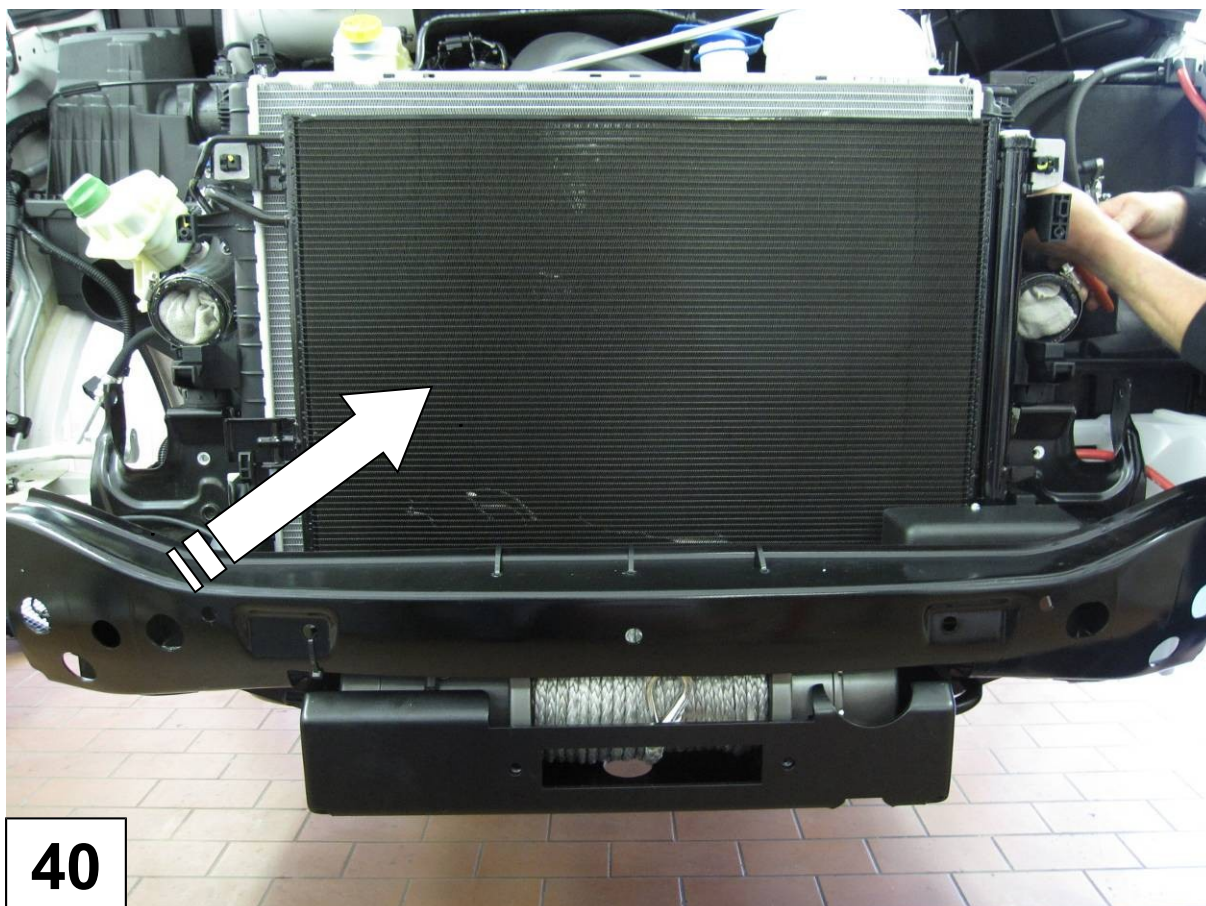
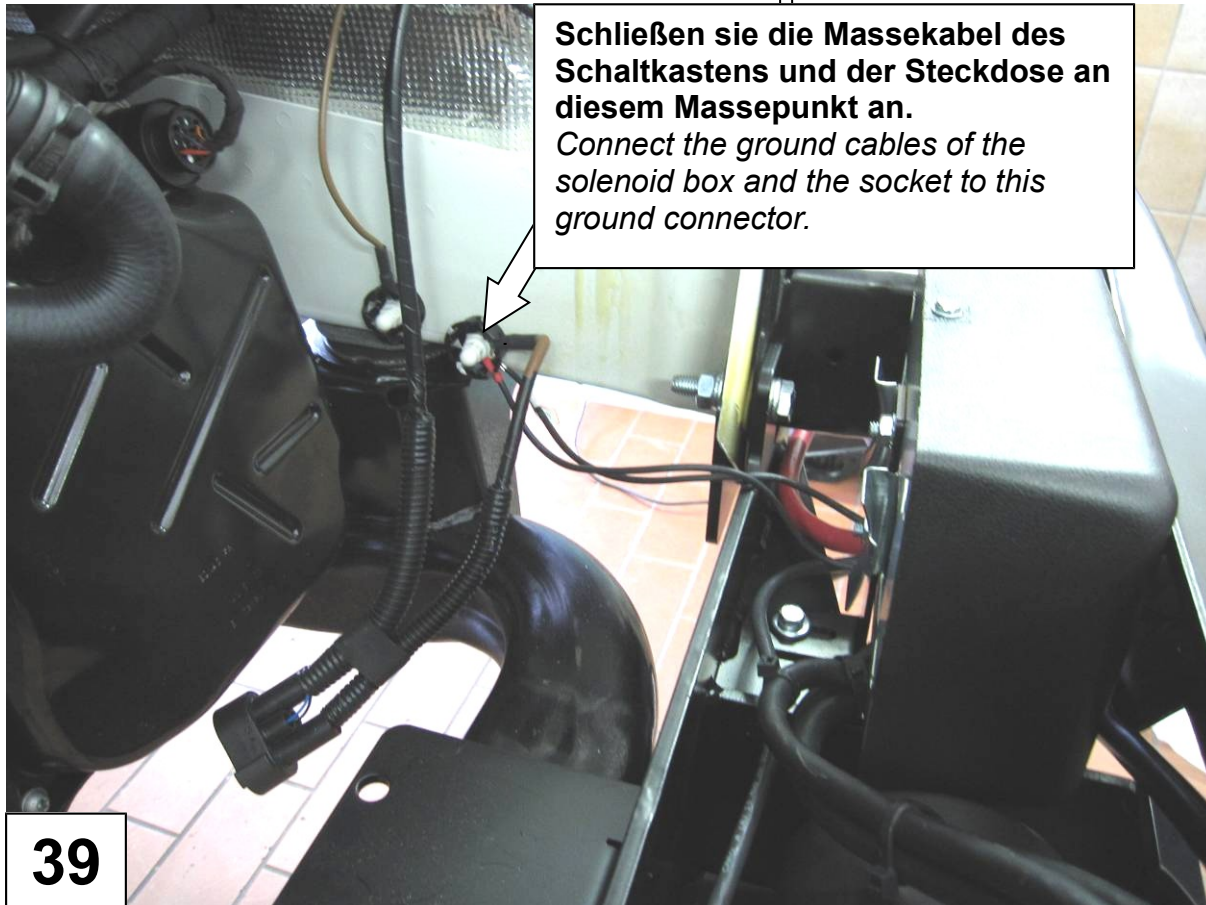

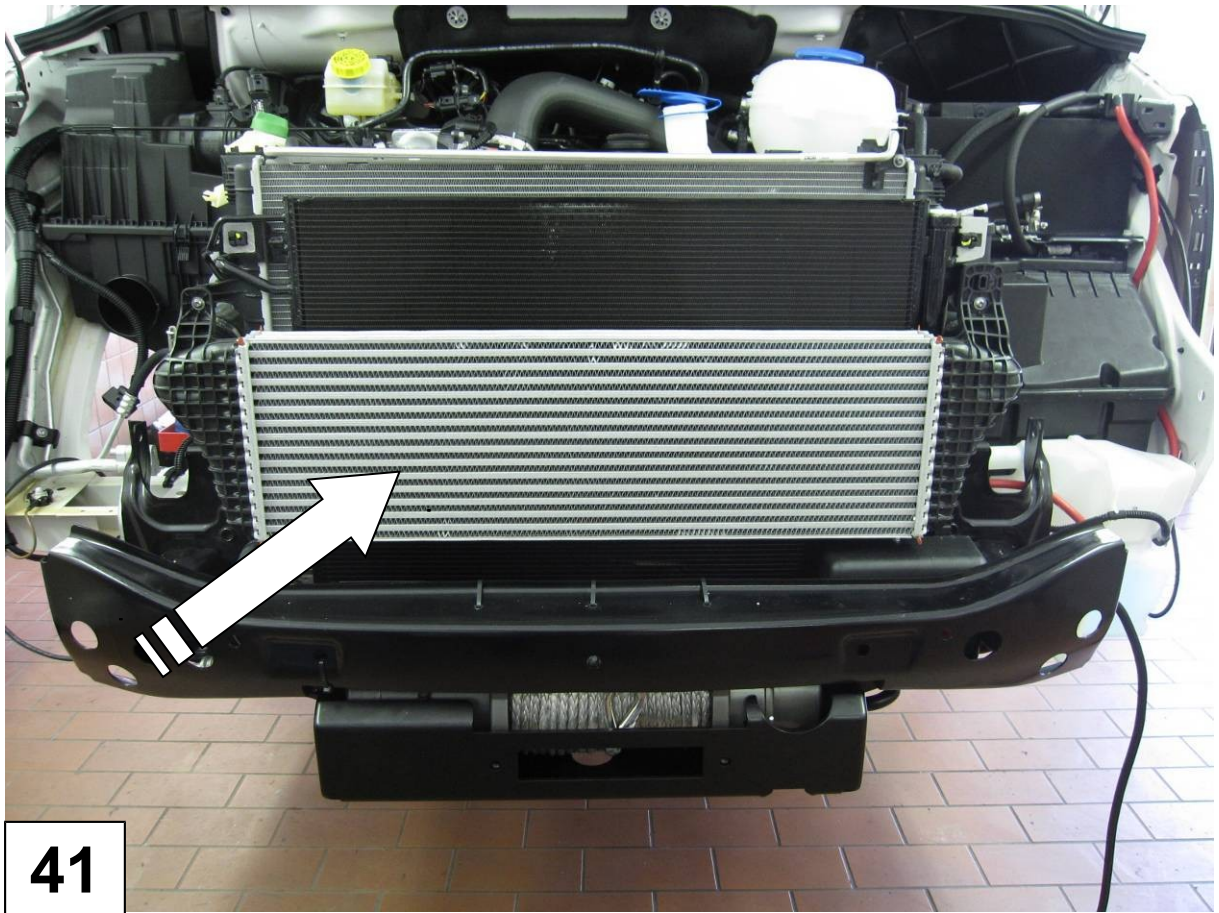

41



42



43



44

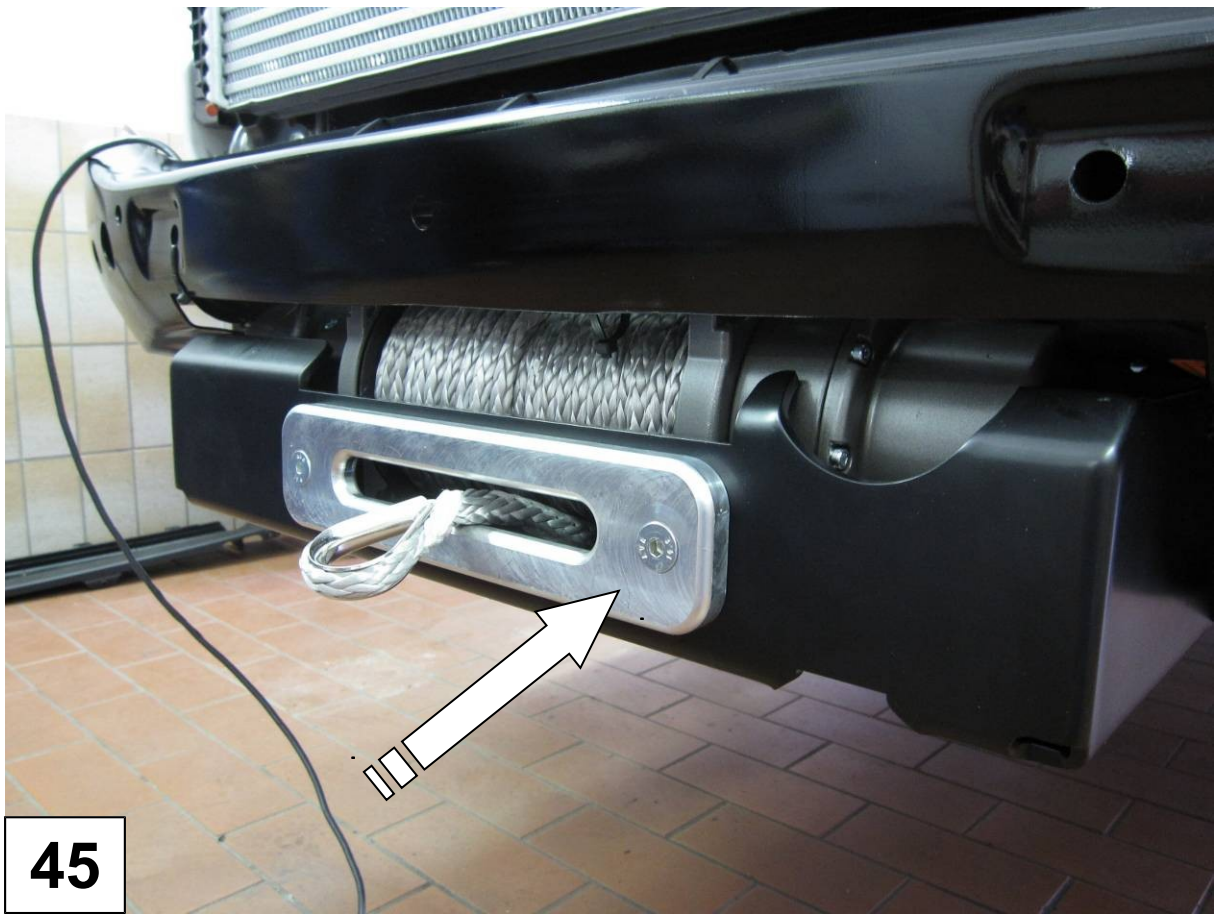

45

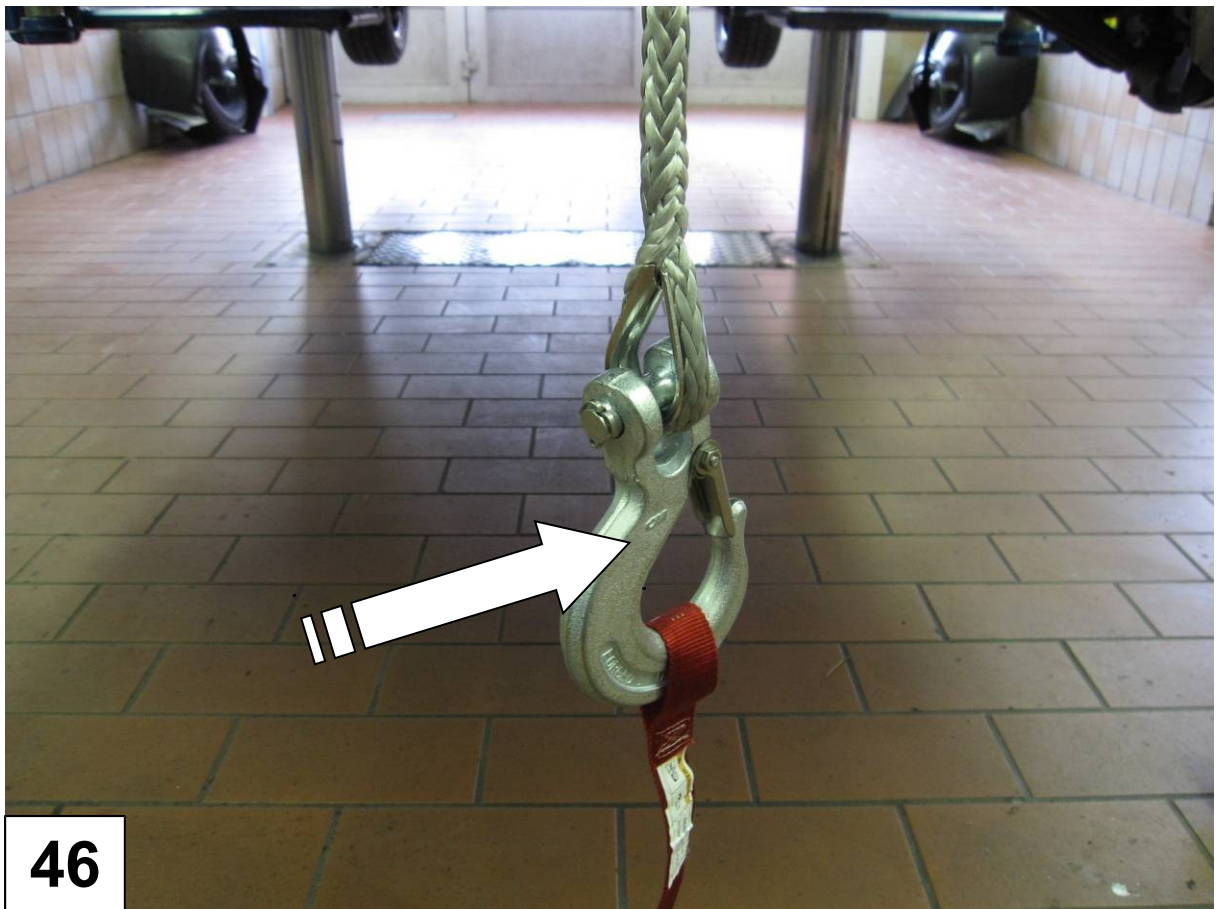

46

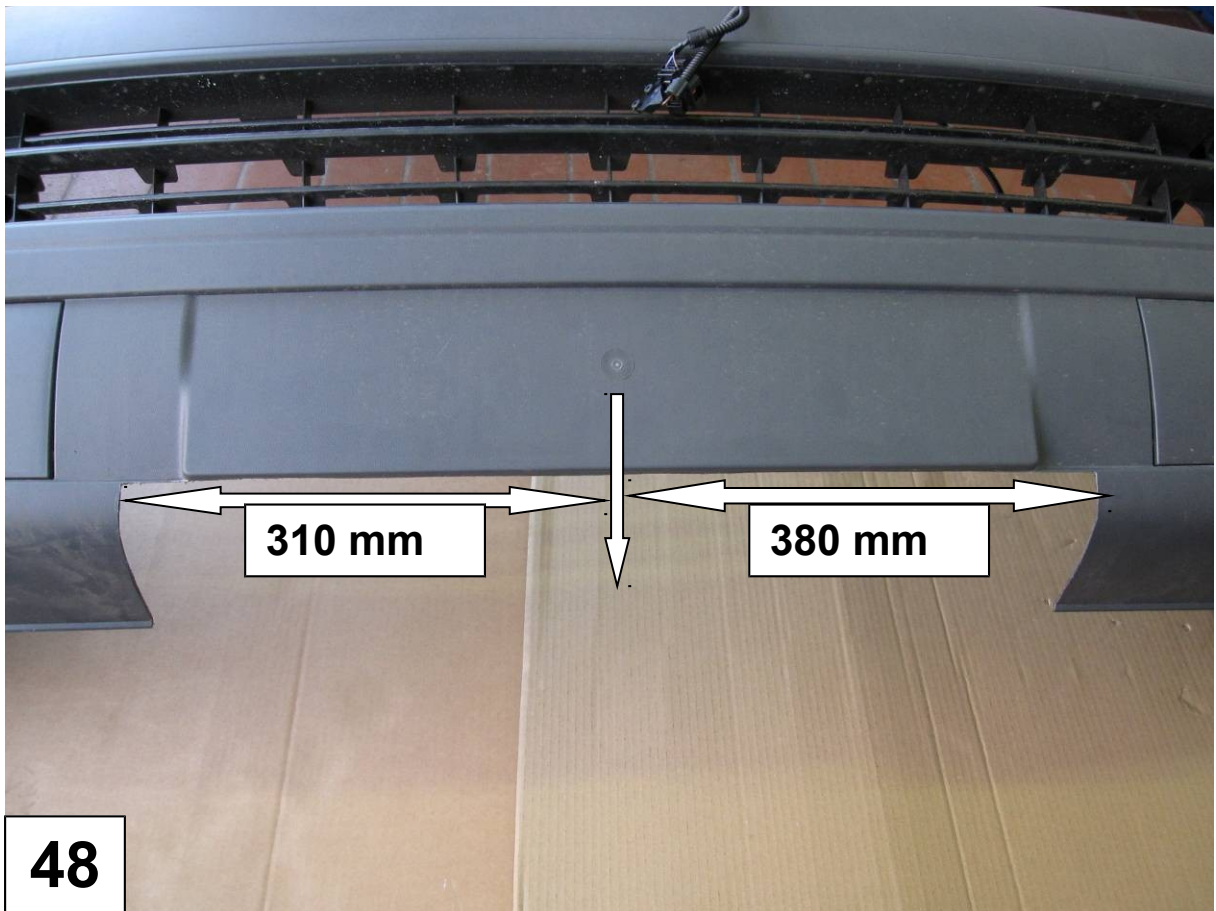
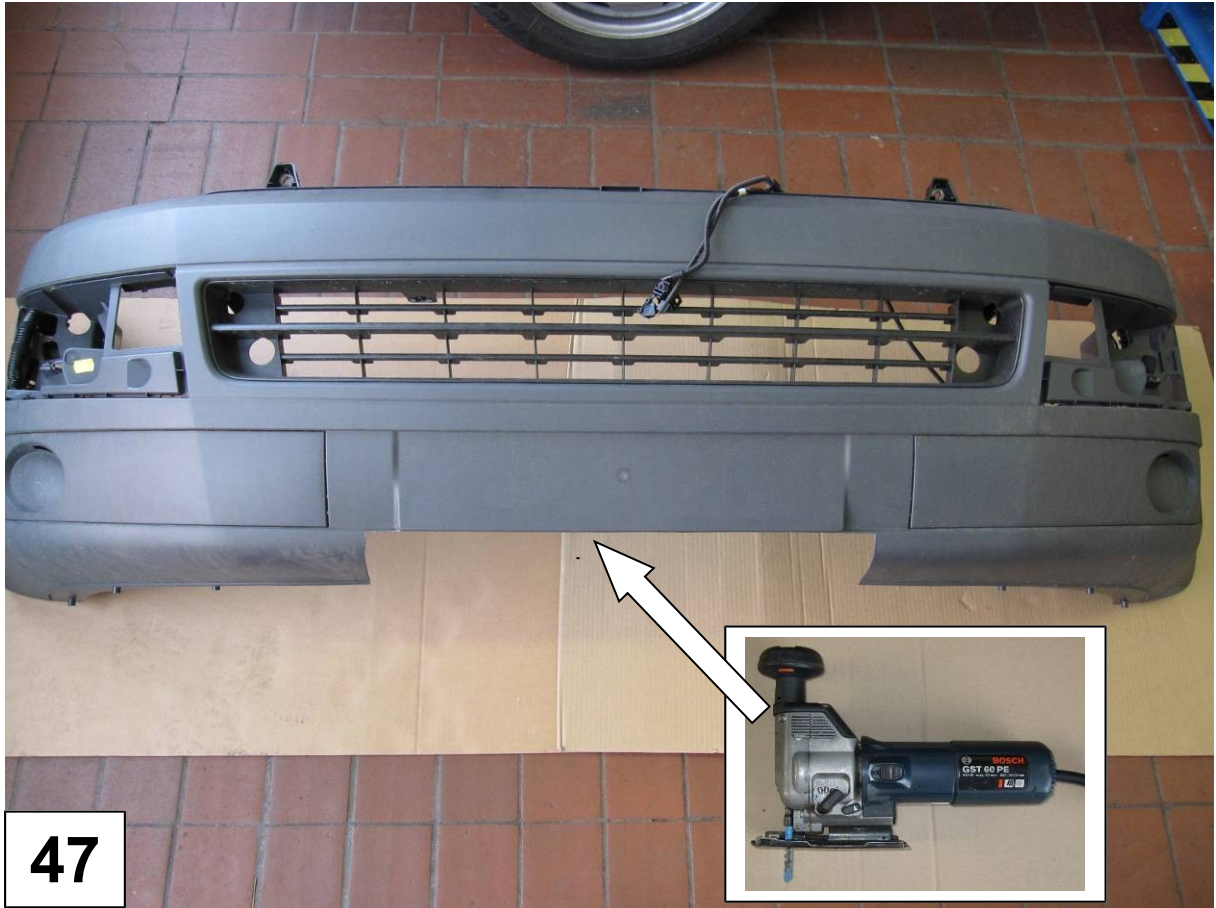

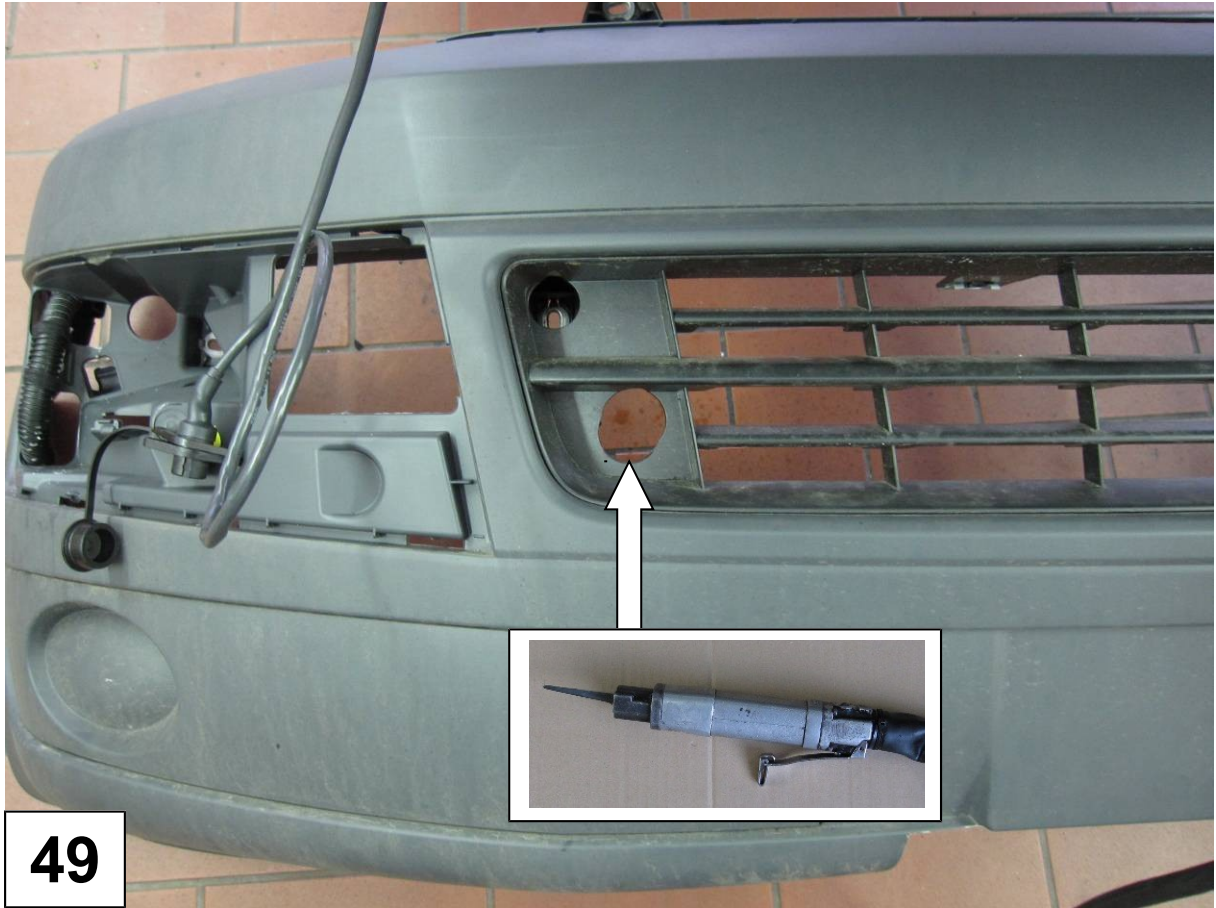

49

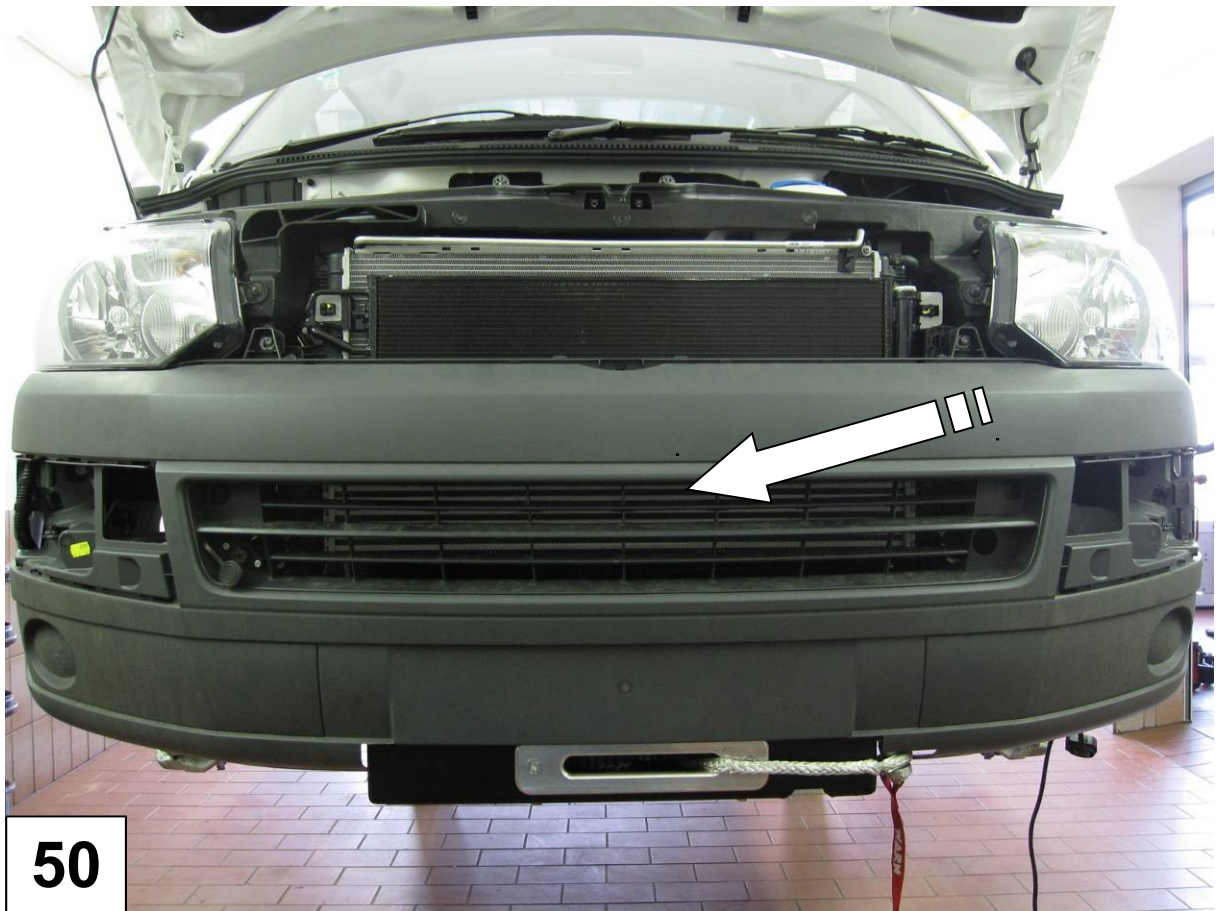

50

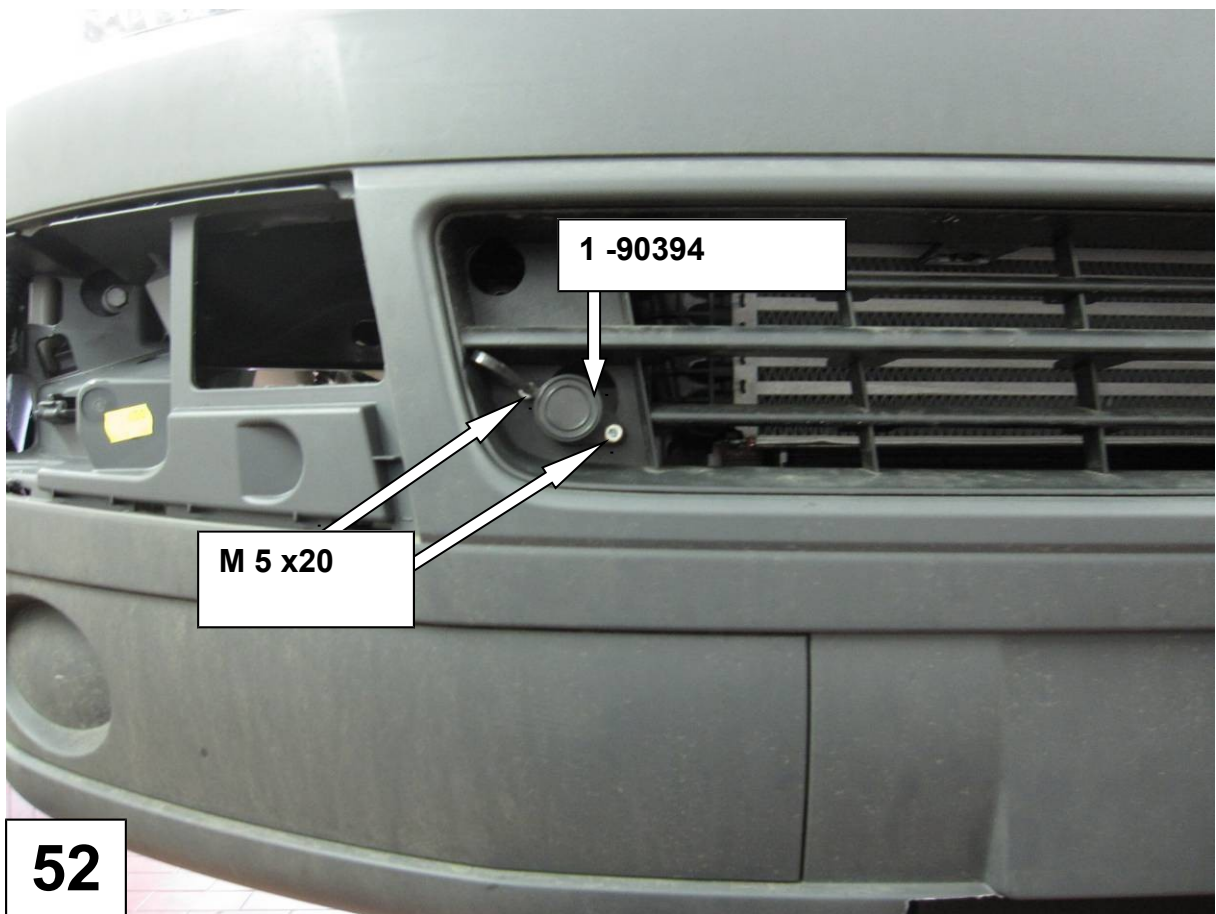
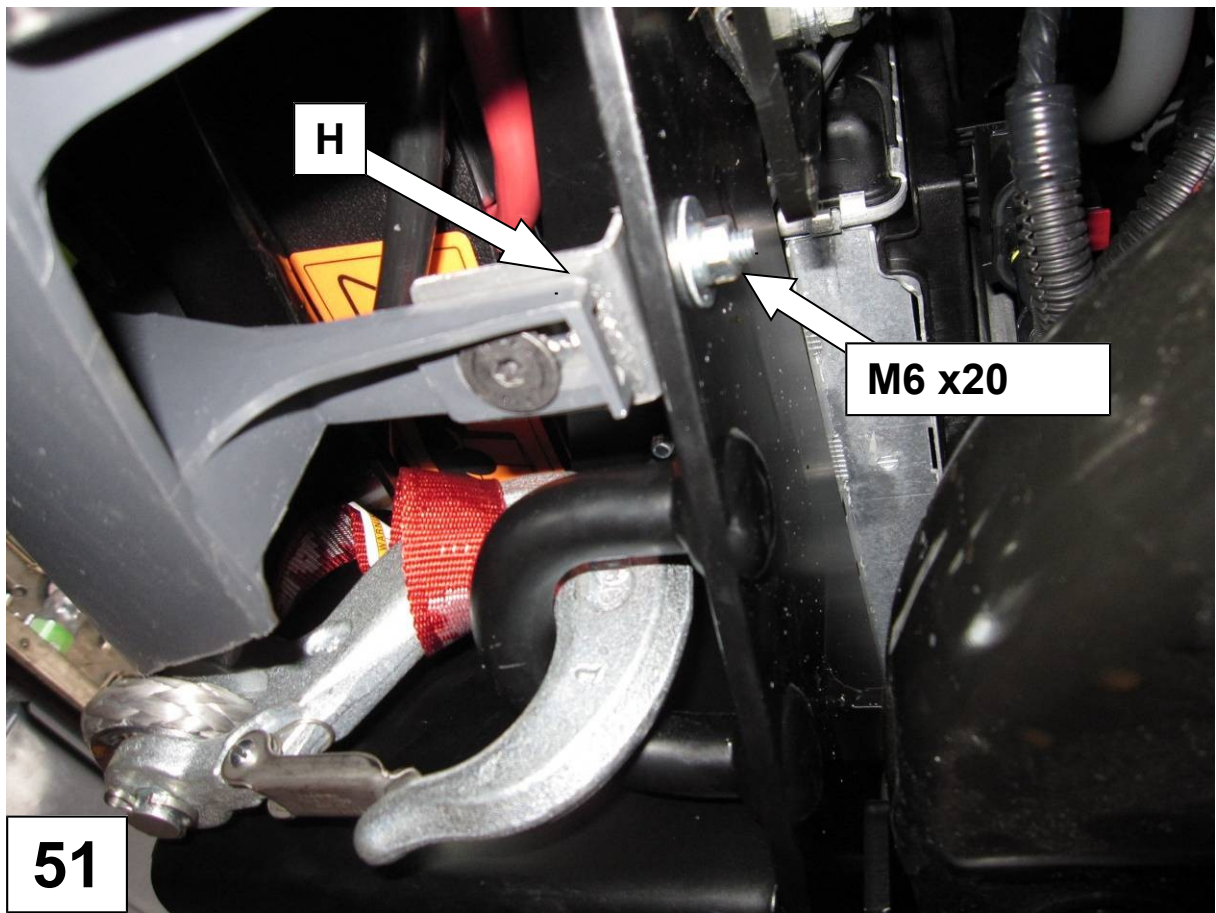



53



54

Anbauanleitung Seilwindenanbausatz VW T5

Best.-Nr.: 16-535

AL: 1174 – 03



**Hier sehen sie den fertig montierten Seilwindenanbausatz.
Bevor sie mit der Montage beginnen lesen sie bitte diese Anleitung
und das Benutzerhandbuch der Seilwinde gut durch.**

Achtung:

Bei Fahrten im öffentlichen Straßenverkehr muß das Rollenseilfenster mit einer Kunststoffabdeckung abgedeckt werden.

Stückliste

Seilwindenanbausatz VW T5

Best.nr.: 16-535

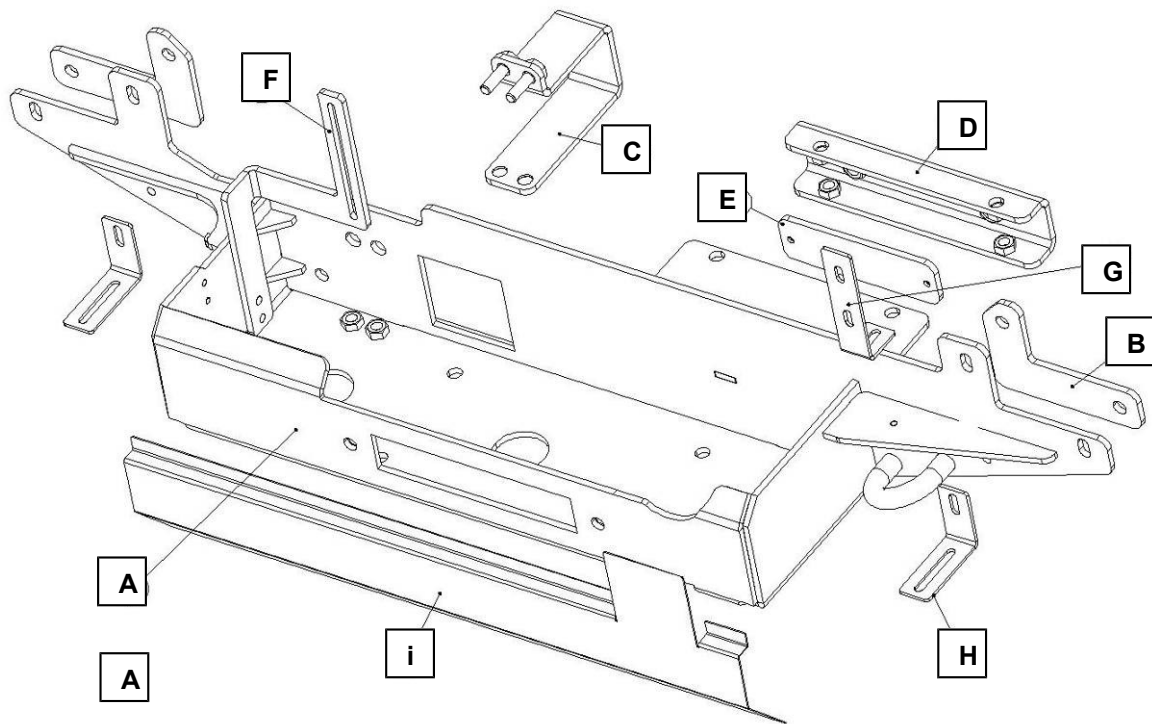

1 x Seilwindenträger (A)		2 x Schraube M 12 x 60
2 x Verstärkungsblech (B)		2 x Federring M 12
1 x Sicherungsbügel (C)		4 x U – Scheibe M 12
1 x Klemmstück (D)		4 x Mutter M 12
1 x Druckplatte (E)		4 x Senkkopfschraube M10 x 25
1 x Schaltkastenhalter (F) bis 2010		2 x Schraube M 10 x 25
1 x Schablone (i) bis 2010		4 x Schraube M 10 x 50
1 x Schaltkastenhalter (G)	ab 2010	6 x Federring M 10
2 x Stoßfängerhalter (H)	ab 2010	10 x U – Scheibe M 10
		4 x Mutter M 10
1 x Anleitung AL 1174		2 x Schraube M 6 x 20
1 x Gutachten		2 x Federring M 6
		2 x U – Scheibe M 6 x 20 x 2

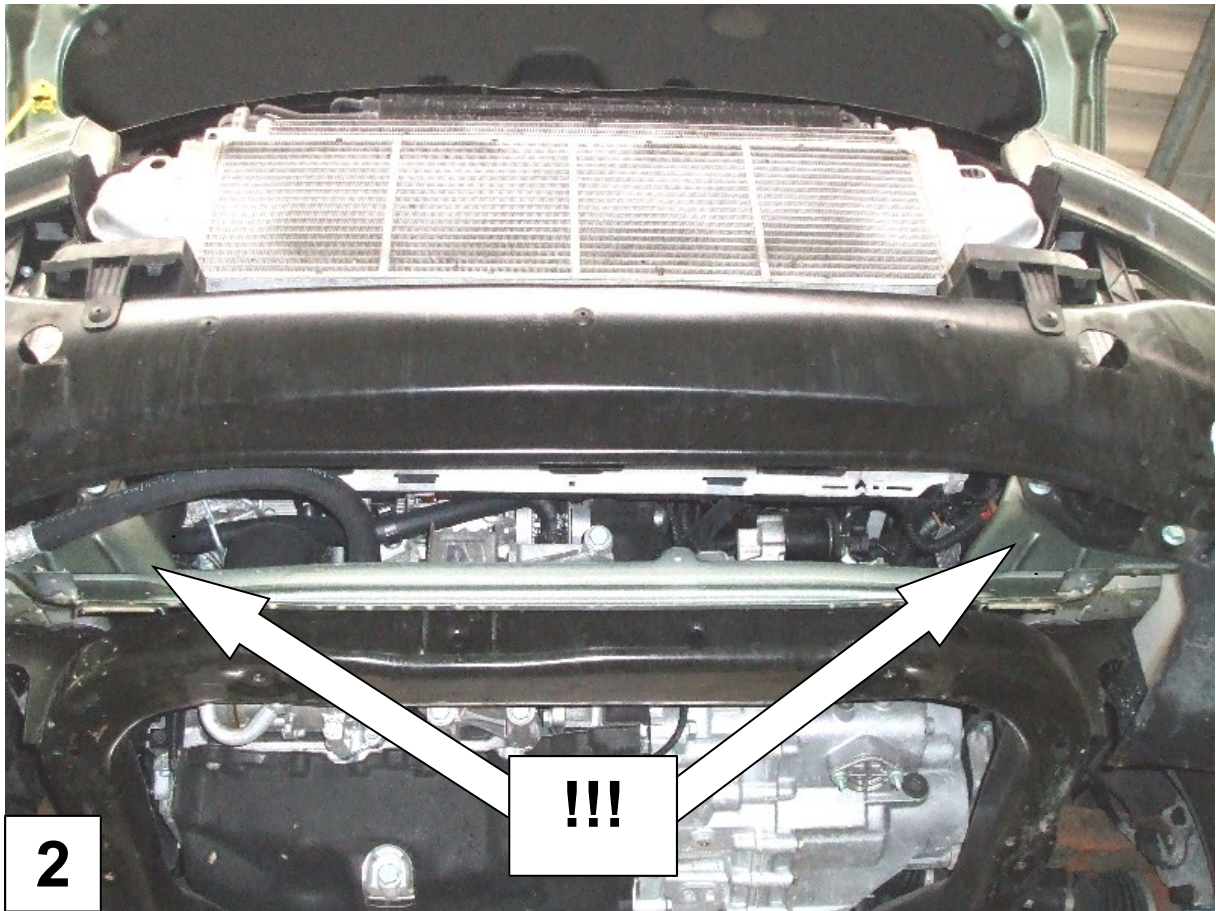



3



4

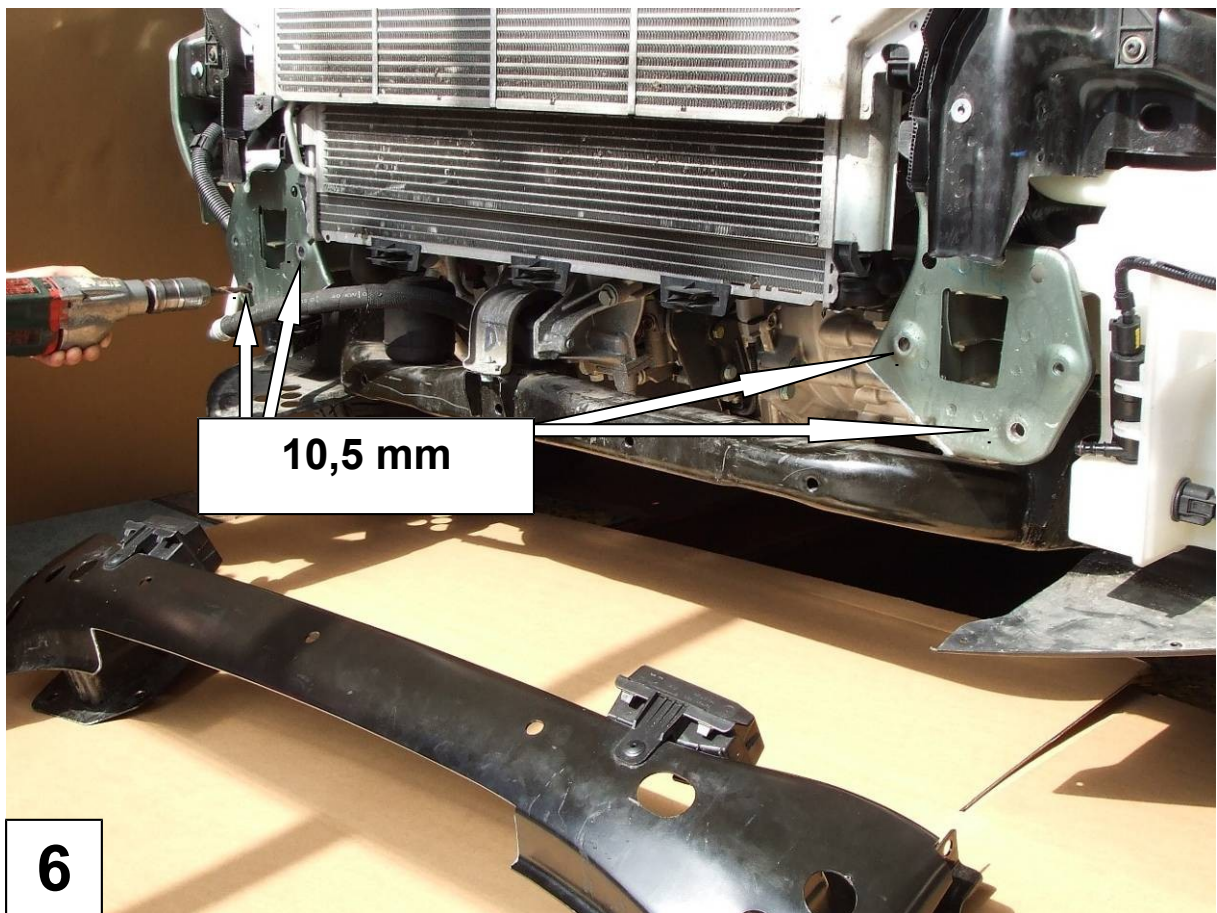
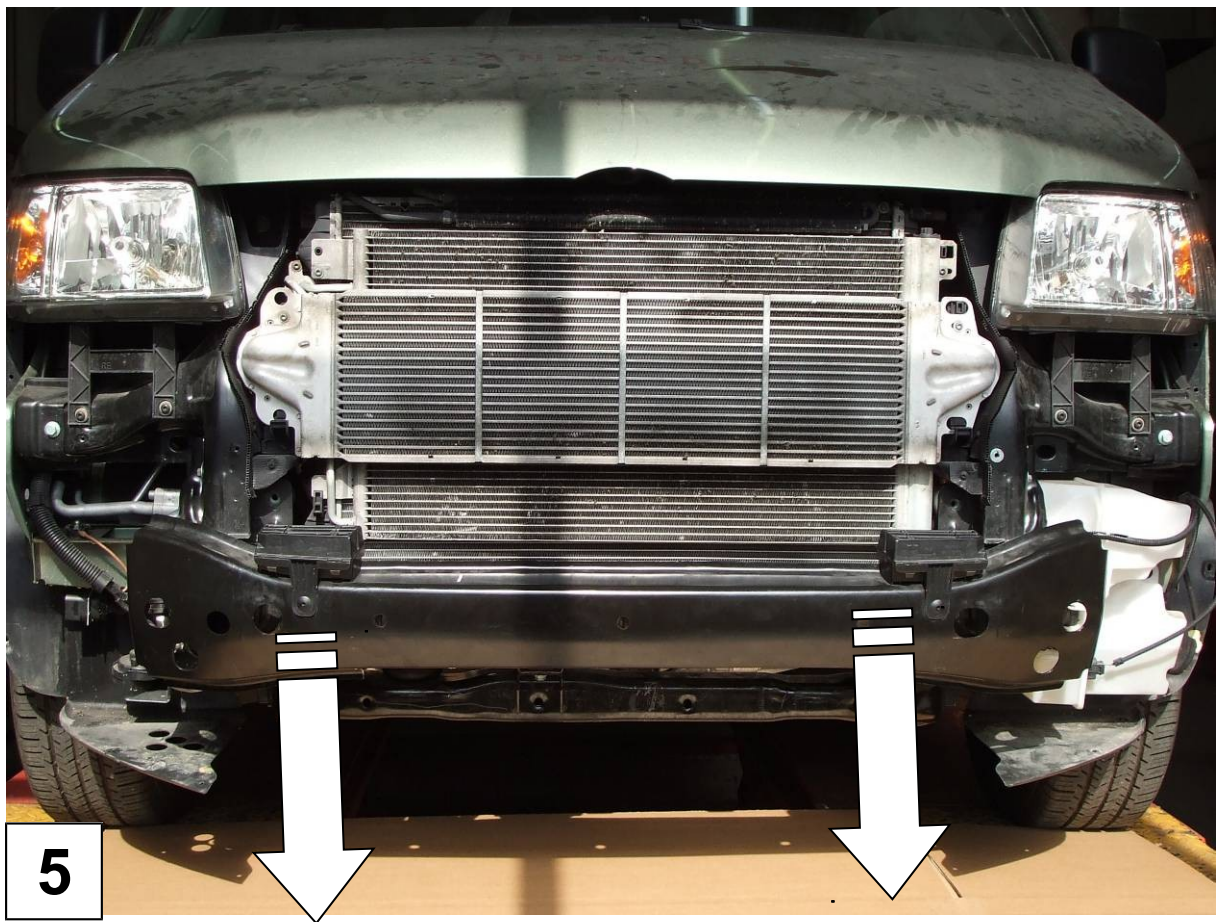

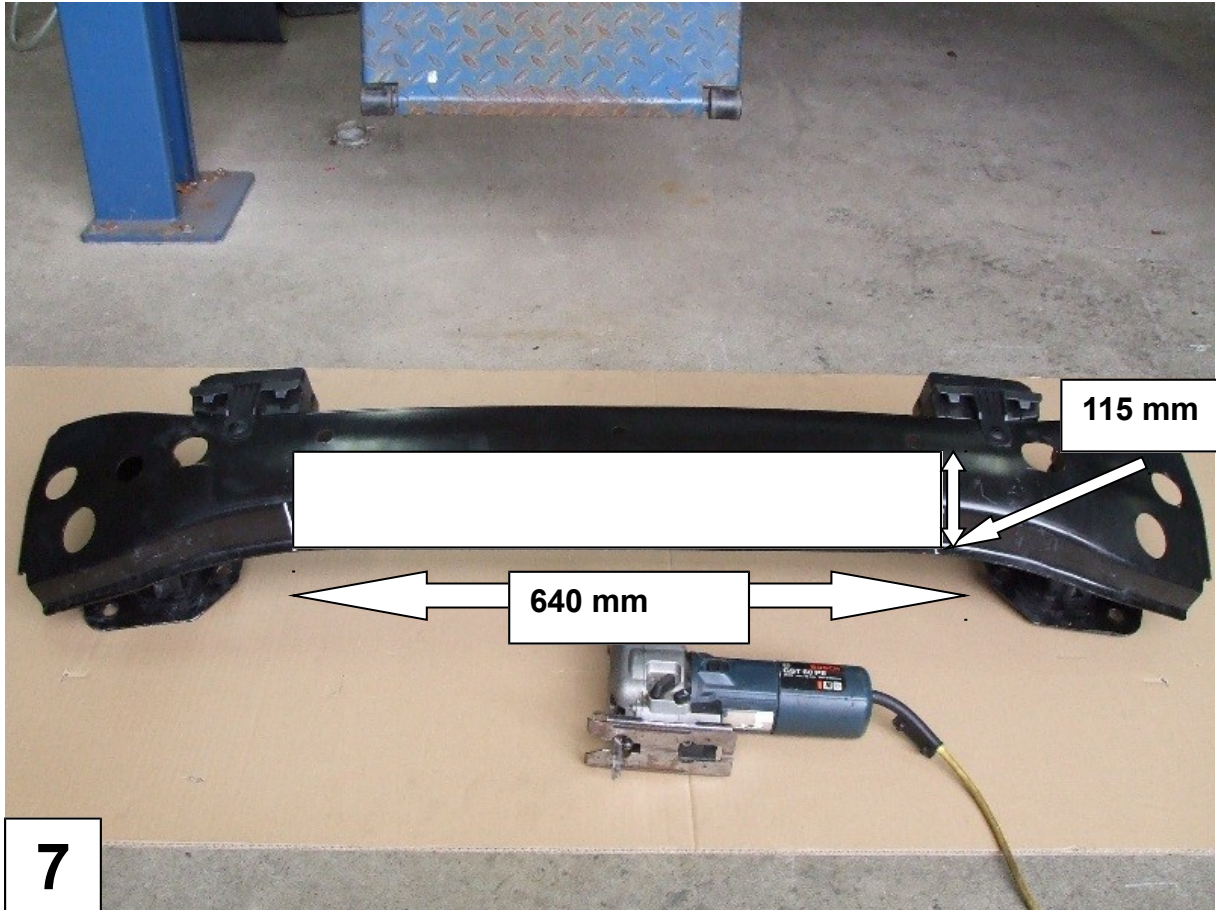

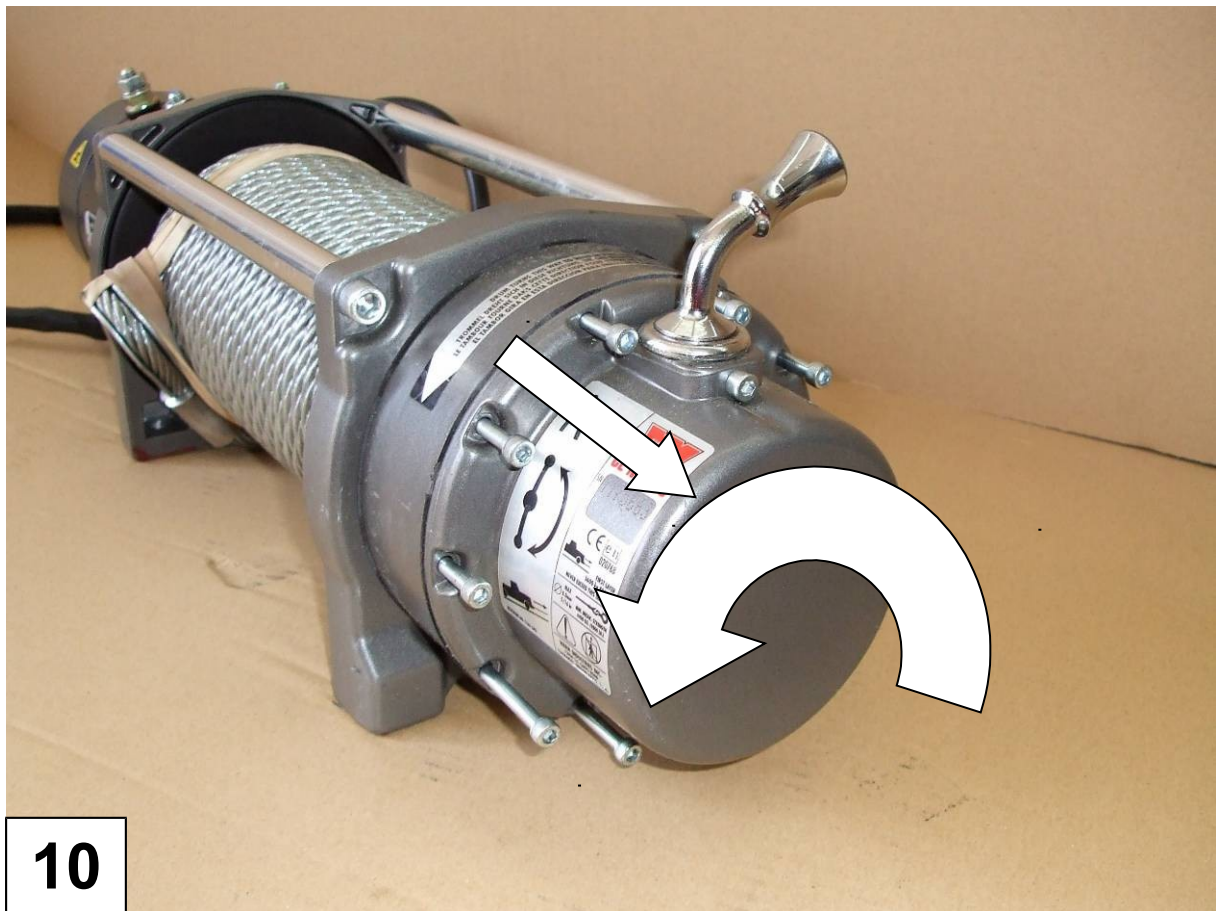
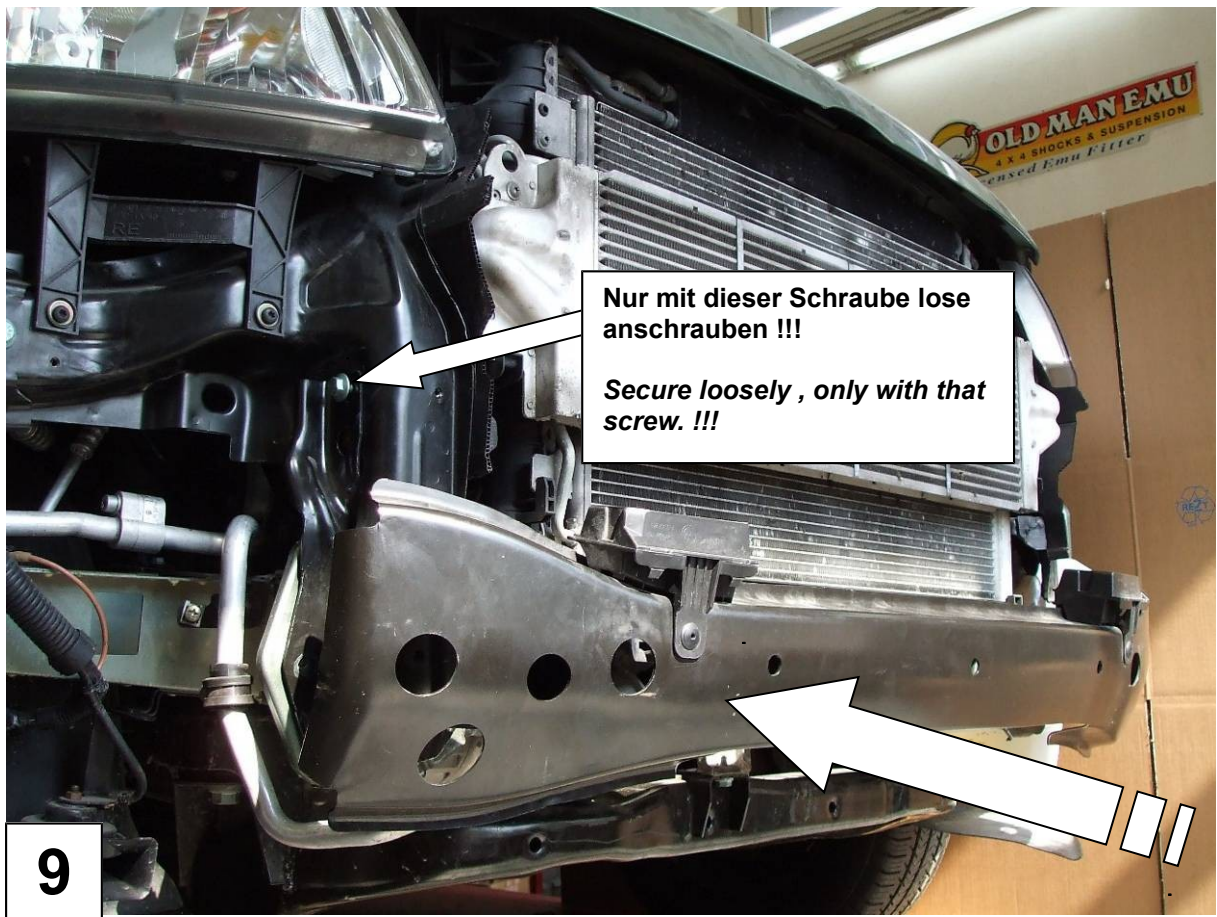

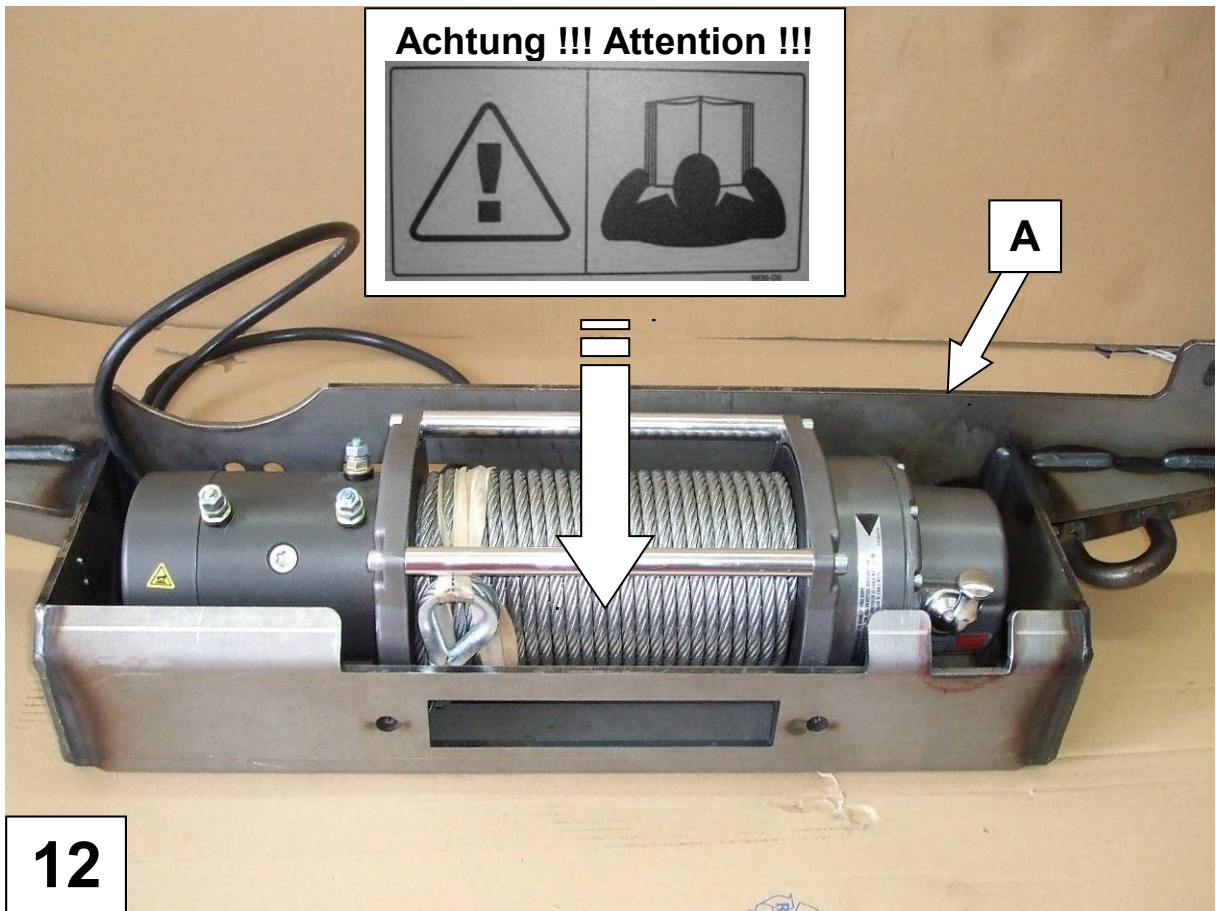

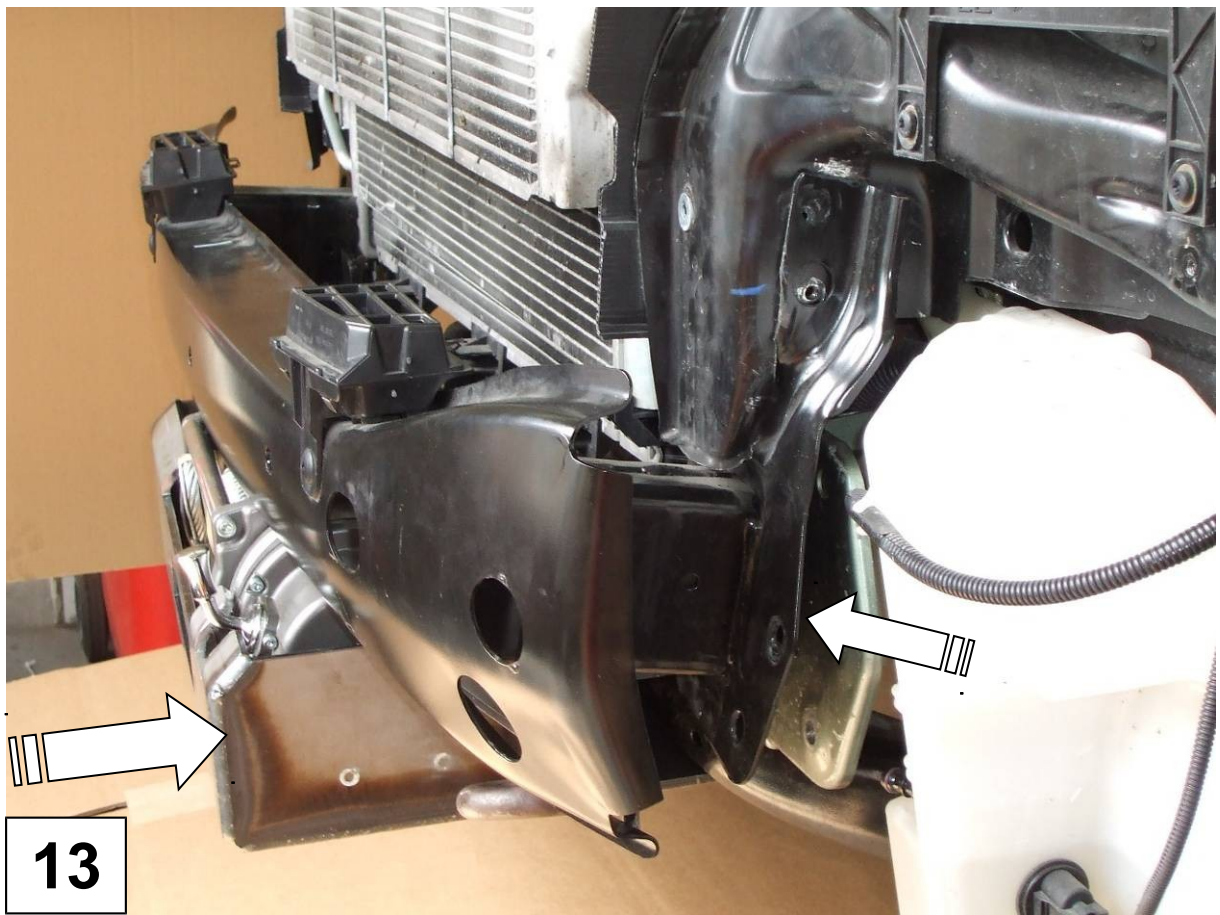

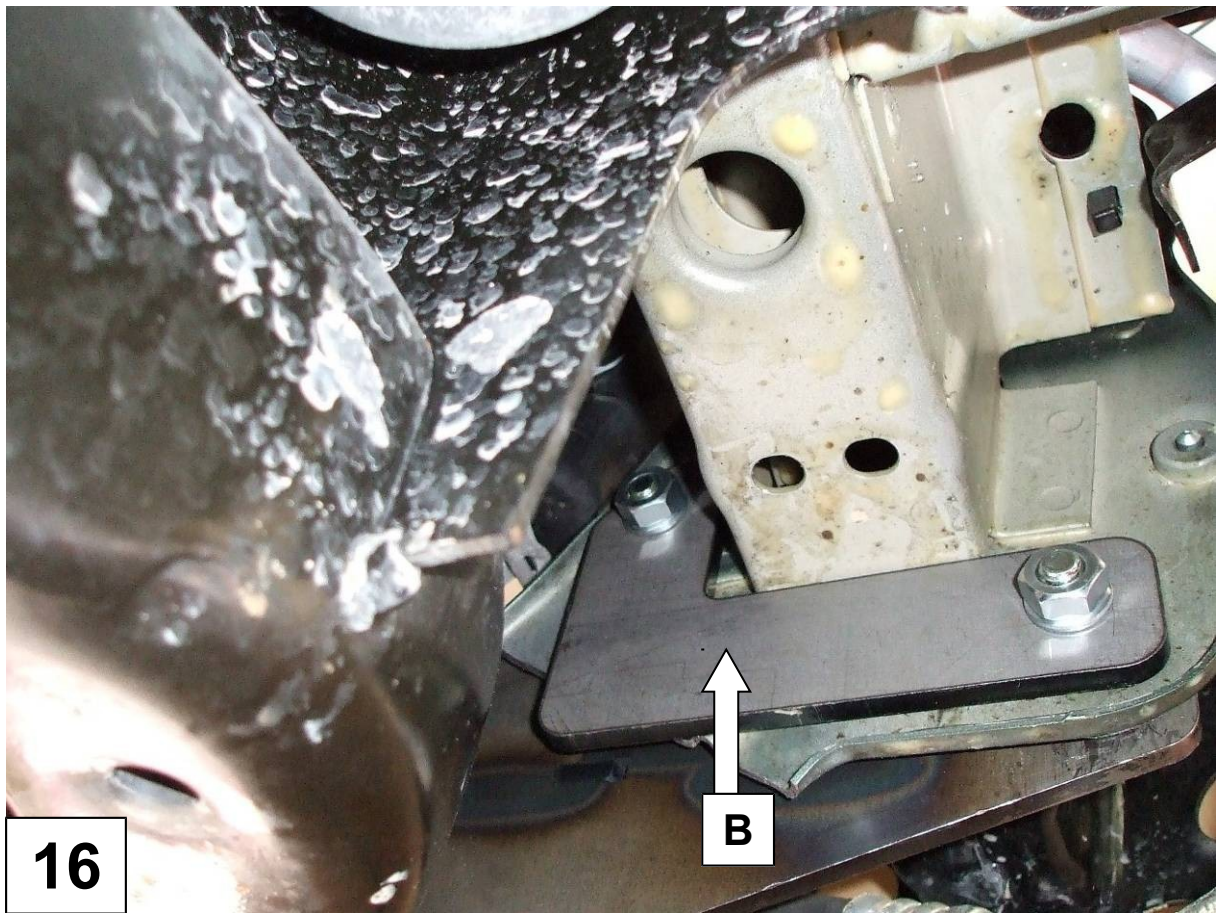
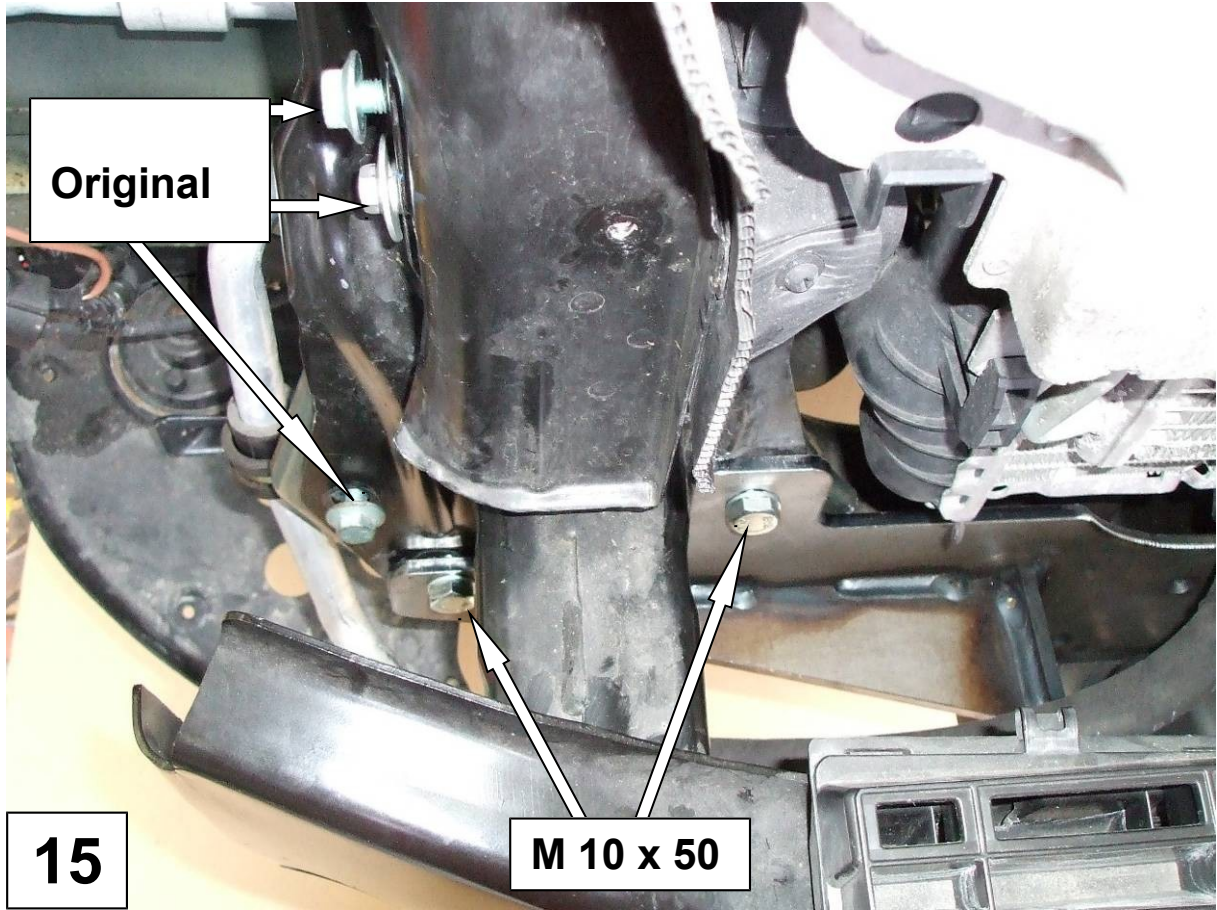

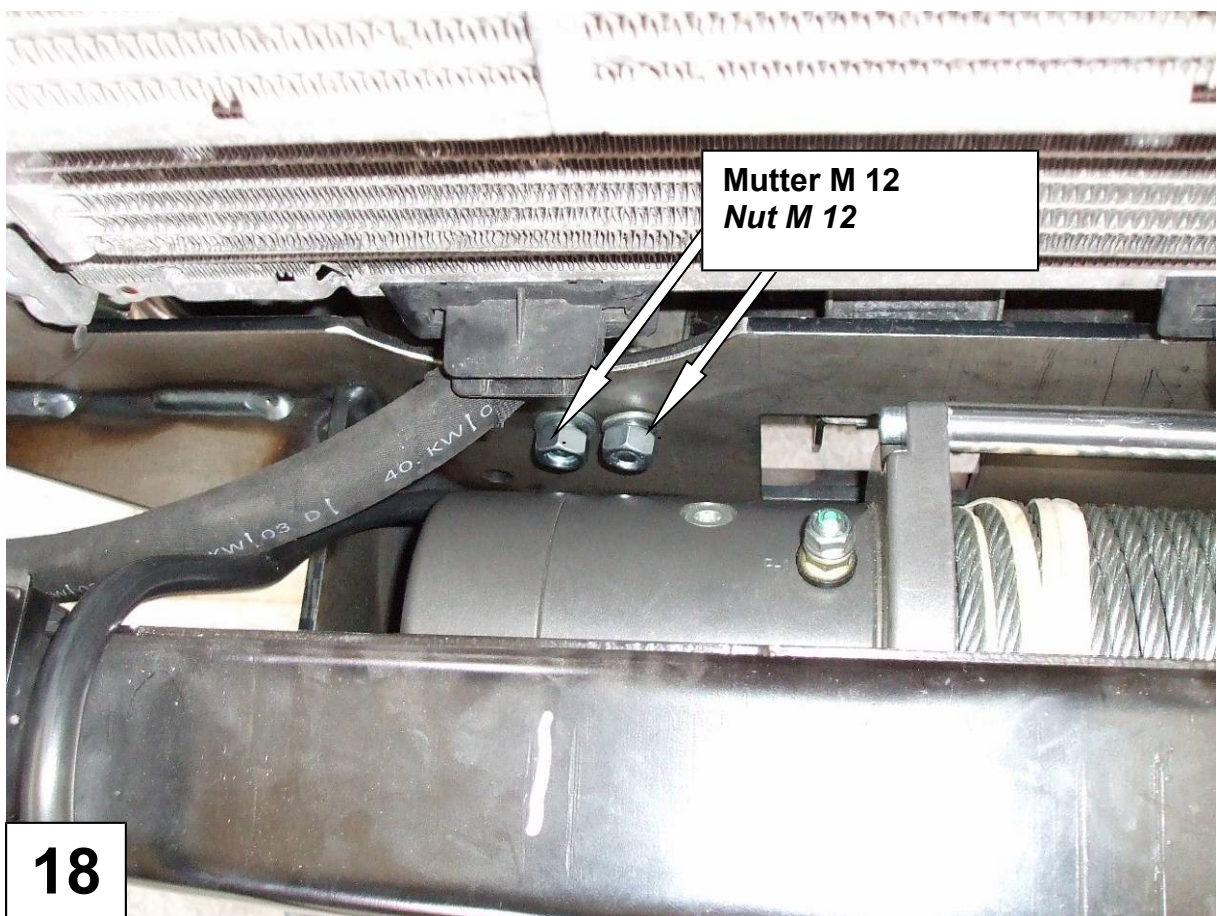
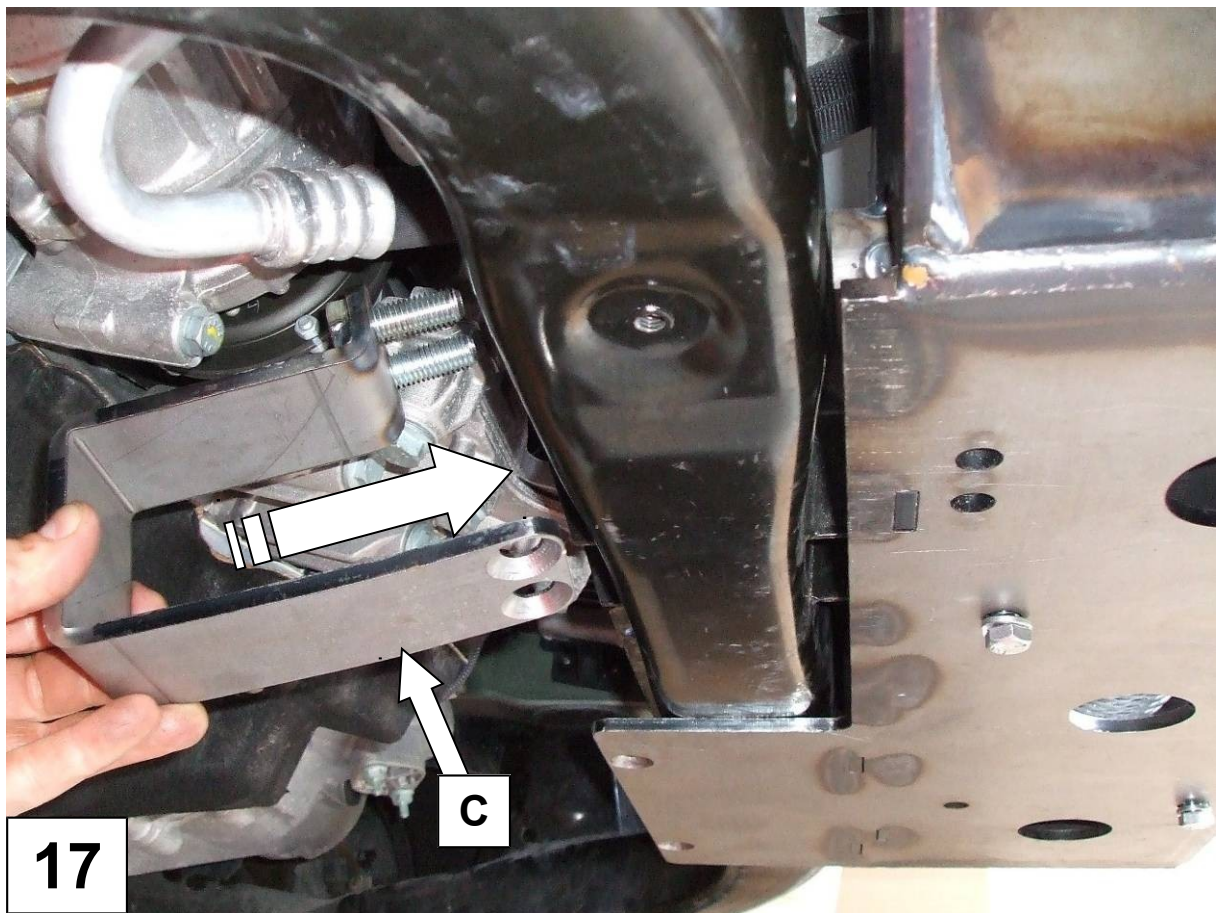

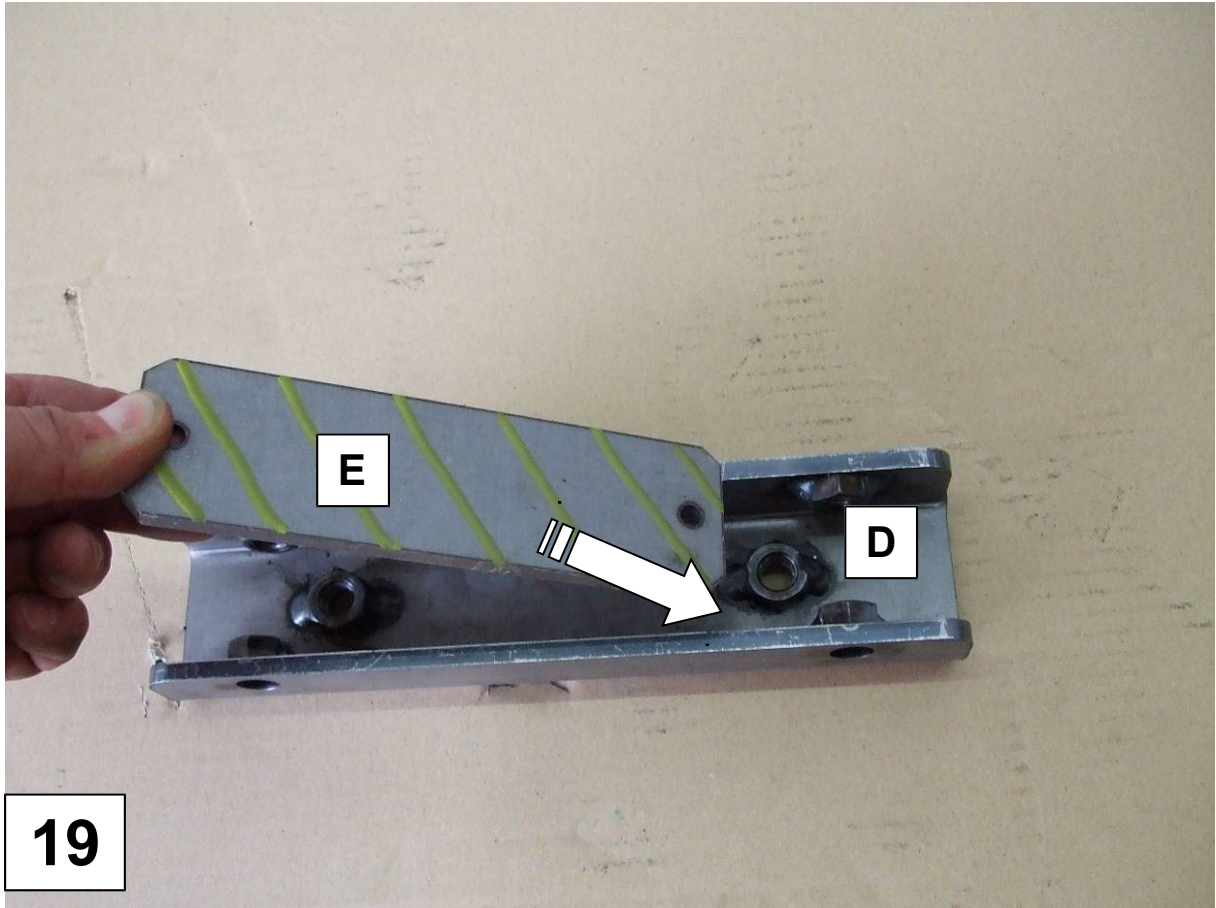

19

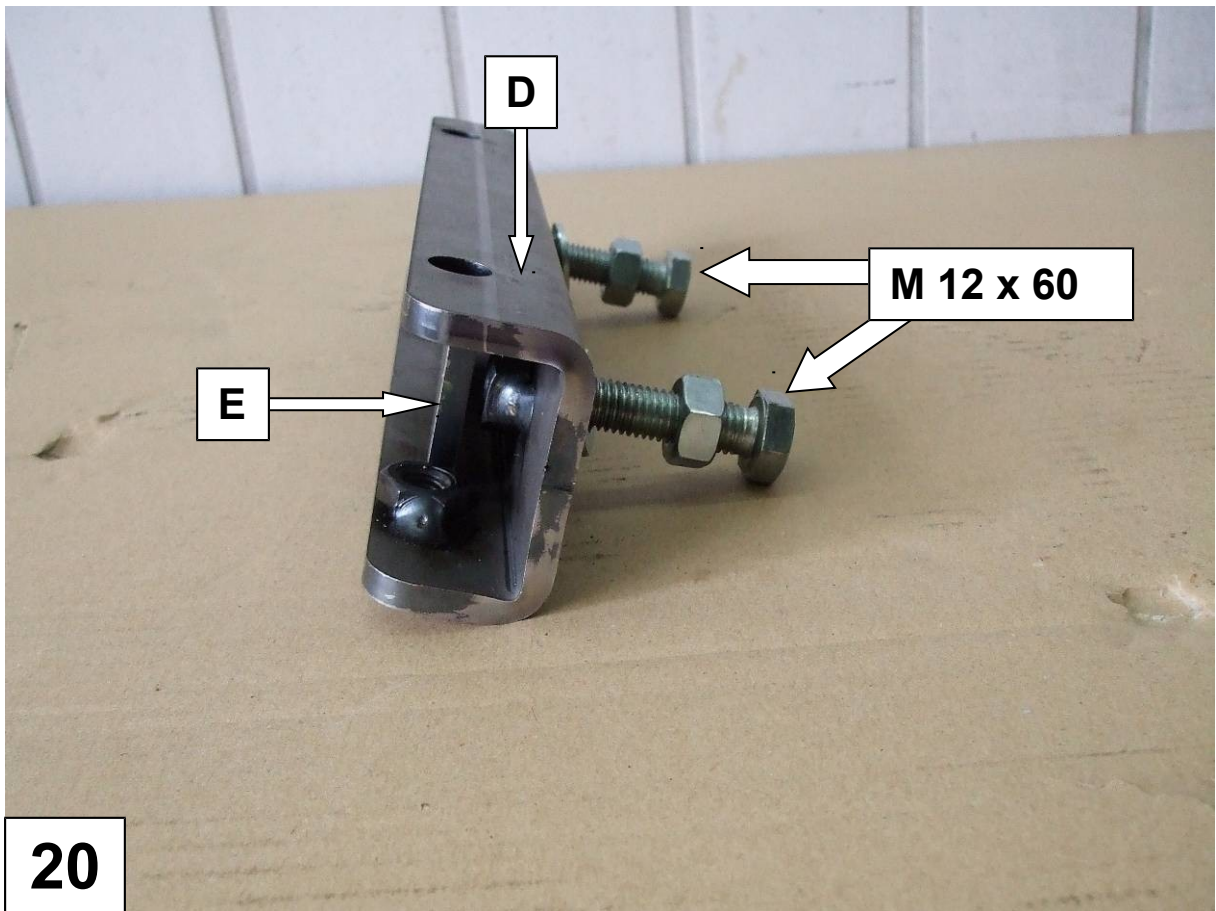

20

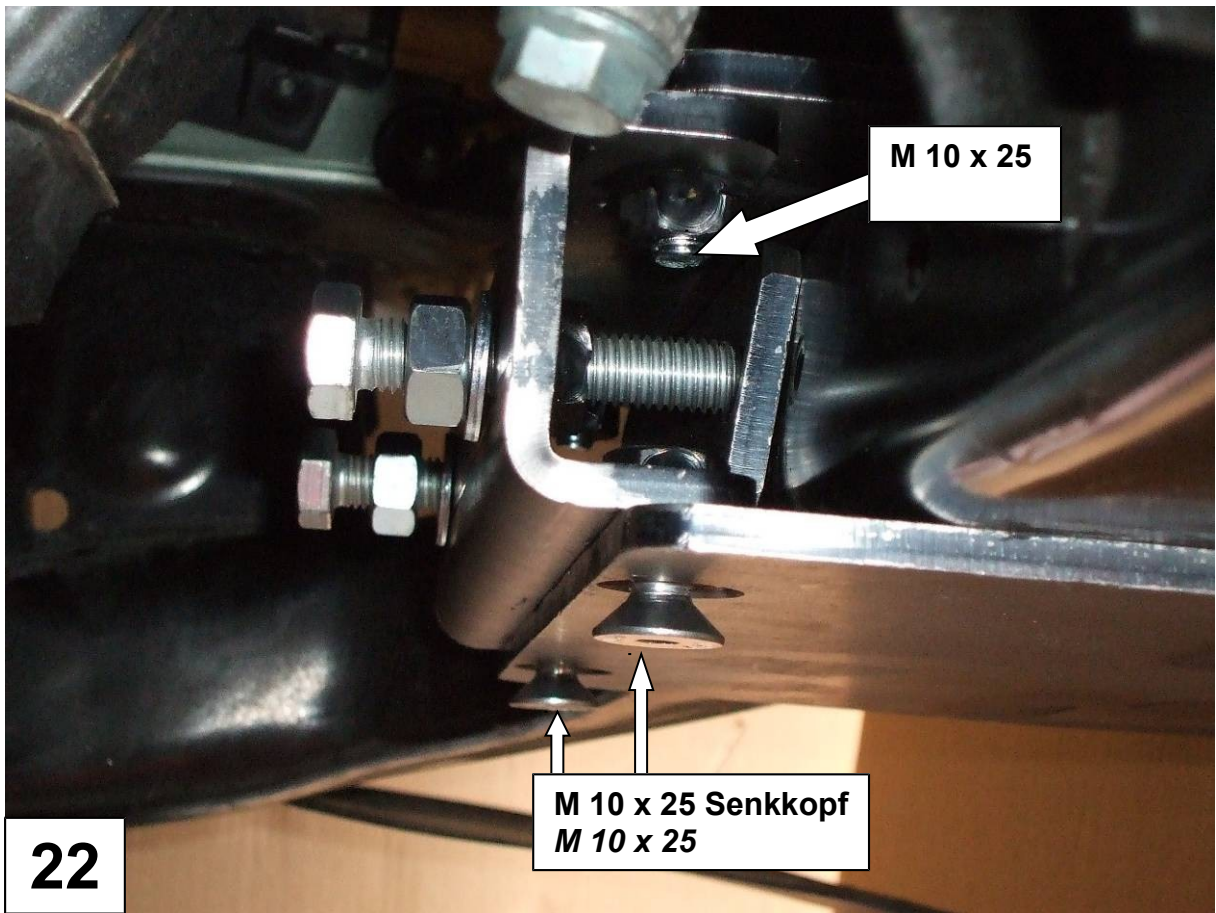
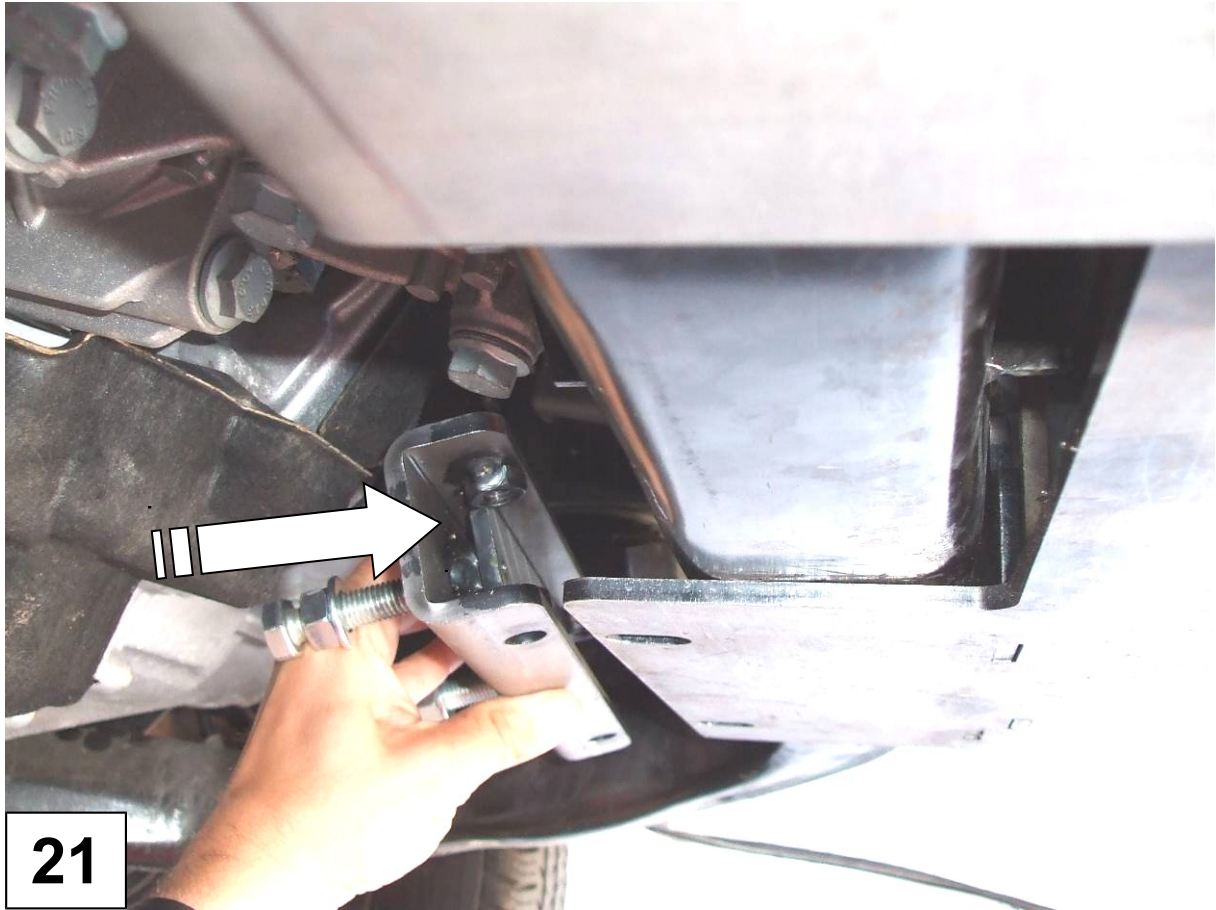

Ziehen sie die Schrauben in folgender Reihenfolge fest .

Tighten the screws in the following raw.

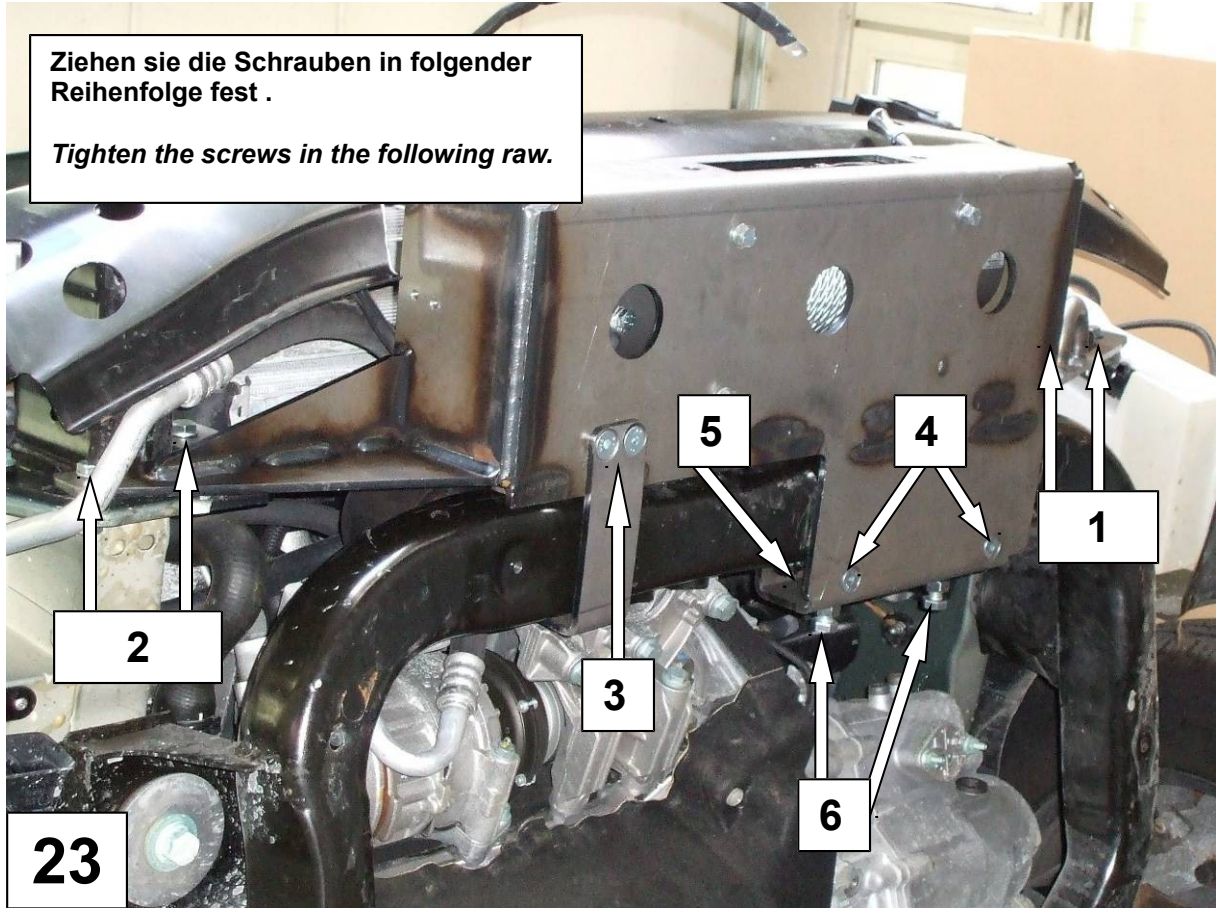

Achtung !!! Attention !!!

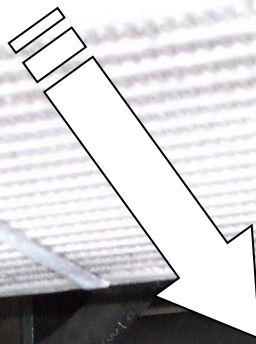
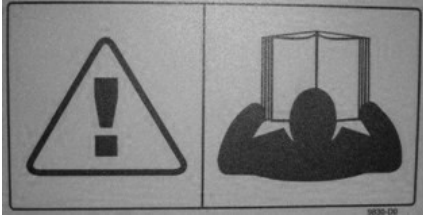

25

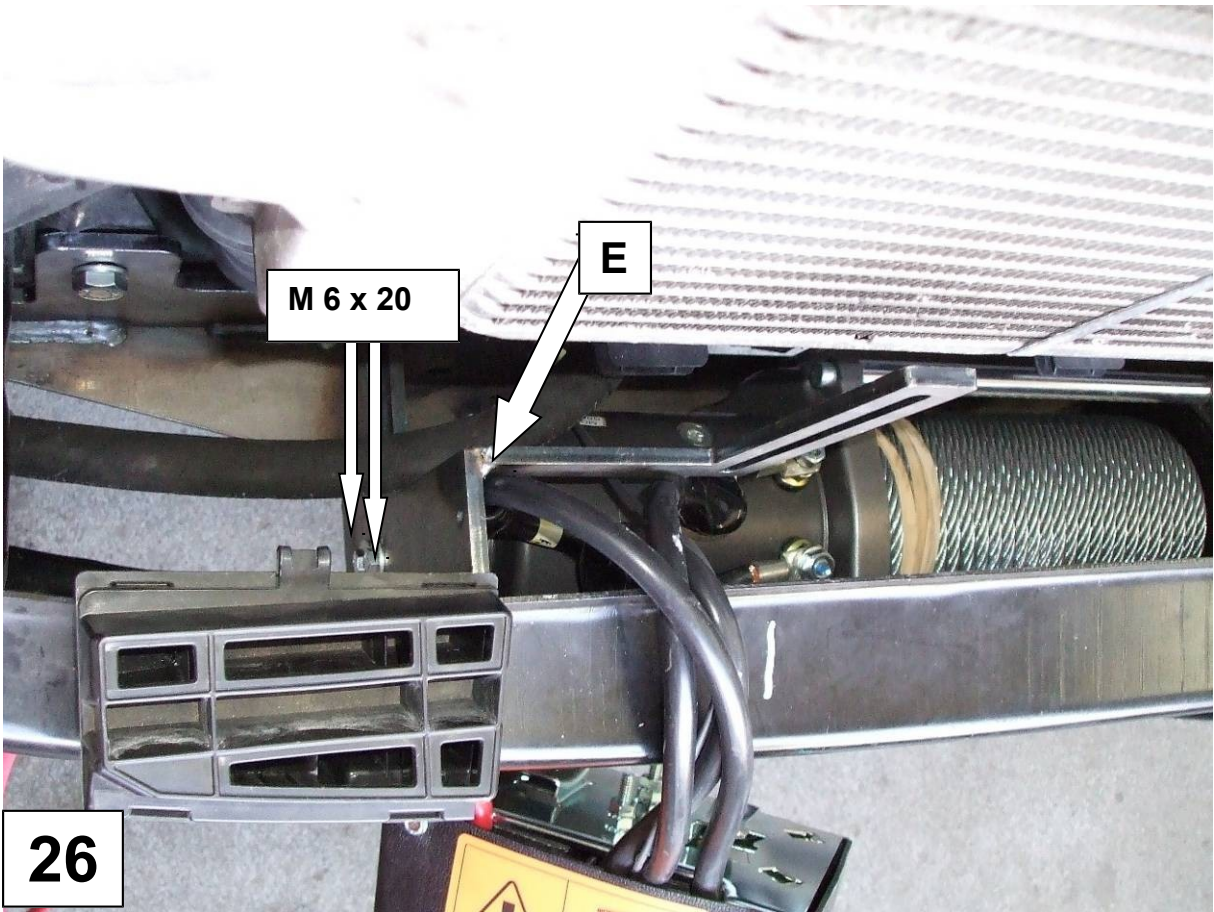

26

M 6 x 20

E



27

Ausschneiden, mit Hilfe der Schablone (i)
Cut out, using temperplate (i)

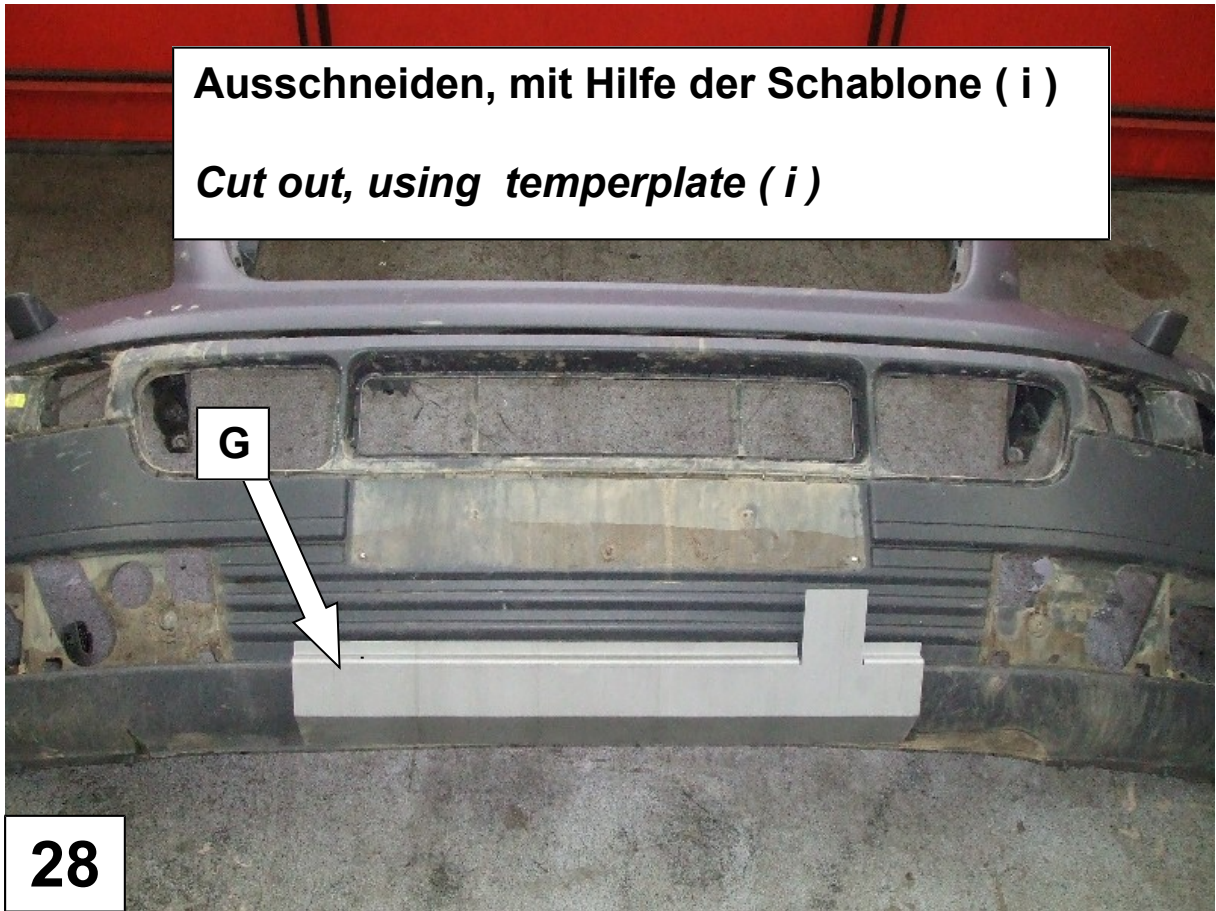

28

